

# SKETCH/AREA TABLE ADDENDUM

## SUBJECT INFO

File No.: 10152019	Parcel No.: 8585-22-4238-000
Property Address: 387 Evergreen Street	
City: Brevard	County: Transylvania
State: NC	ZipCode: 28712
Owner: Lentini, Brian/Margie	
Client: Deborah Betts, Looking Glass Realty	Client Address: 5388 Greenville HWY, Brevard, NC 28712
Appraiser Name: RE Broker: Diane L. Jetton, HMS (828)553-0171	Inspection Date: 10/15/2019

## SKETCH

### APPROXIMATE TOTAL HEATED LIVING AREA

**First Floor = 2,610 SF**

### APPROXIMATE UNHEATED AREA

**Unheated Attic/Storage = 804 SF**

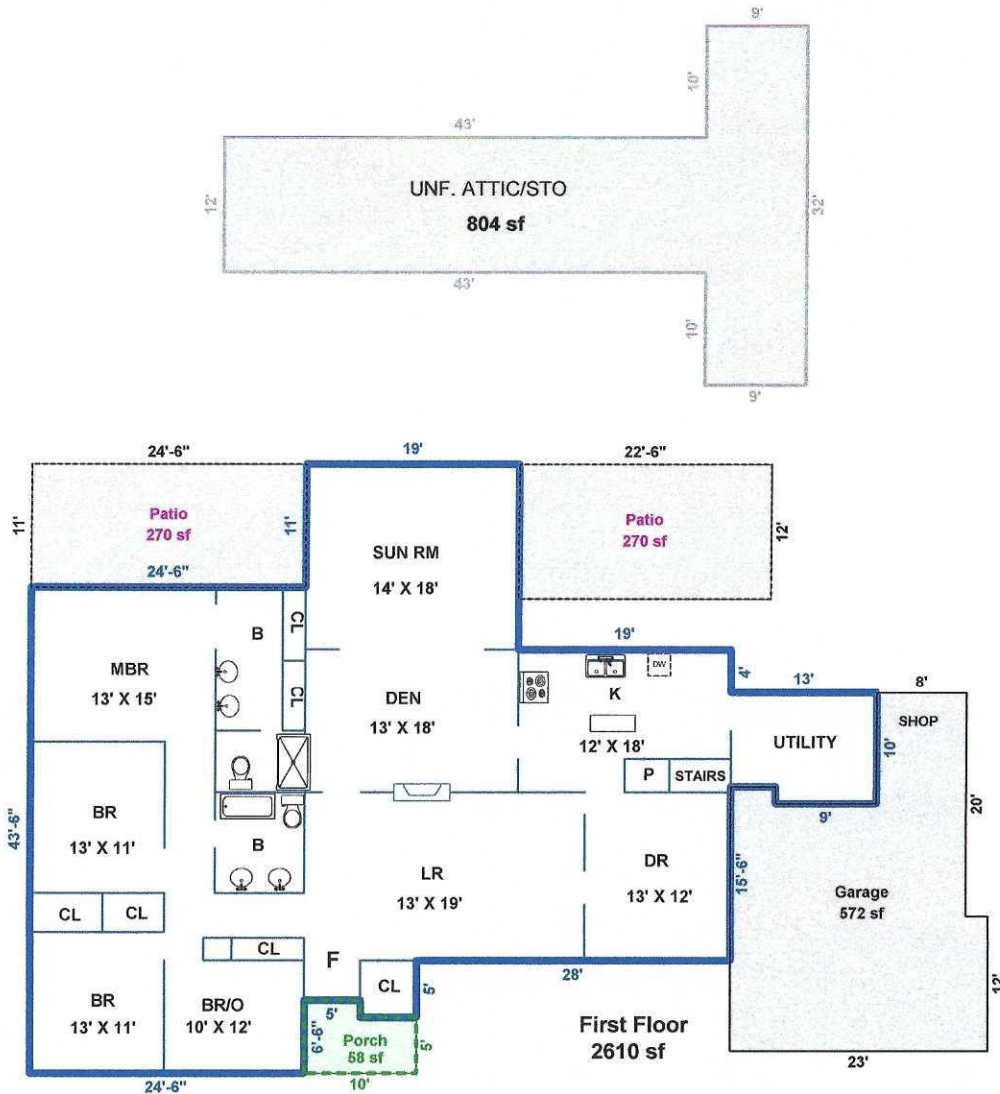

NCREC SF Guidelines permit reporting SF as the total living area without splitting above and below grade SF.  
 Therefore, total living area may be reflected differently by appraisers, lenders, and the NC Building Code.  
 SF calculations follow ANSI Standards and NCREC Guidelines (which are used in this report).  
 Interior sketches are for illustration purposes only and are rounded to the nearest half foot.