

Adding Line

PIN: 8583-76-8316-000 File Name: Still Woods Lot 4 Permit No.: 10-080

TRANSYLVANIA COUNTY DEPARTMENT OF PUBLIC HEALTH

Operation Permit

TOTAL No. of Bdrms: 3 System Type: II Proprietary Name: Infiltrator Chamber Quick 4

Tom Houldsworth Owner's Name Randy Owen System Installer and # 3324 Certification Number

Hull O. Casby REHS Authorized State Agent 6/25/2010 Date of Operation Permit Issuance

This system has been installed in compliance with applicable NC General Statutes, Rules for Sewage Treatment and Disposal and all conditions of the Improvement Permit and Construction Authorization

Septic Tank Manufacturer: Existing STB- Date of Manufacture: Filter Brand: Existing

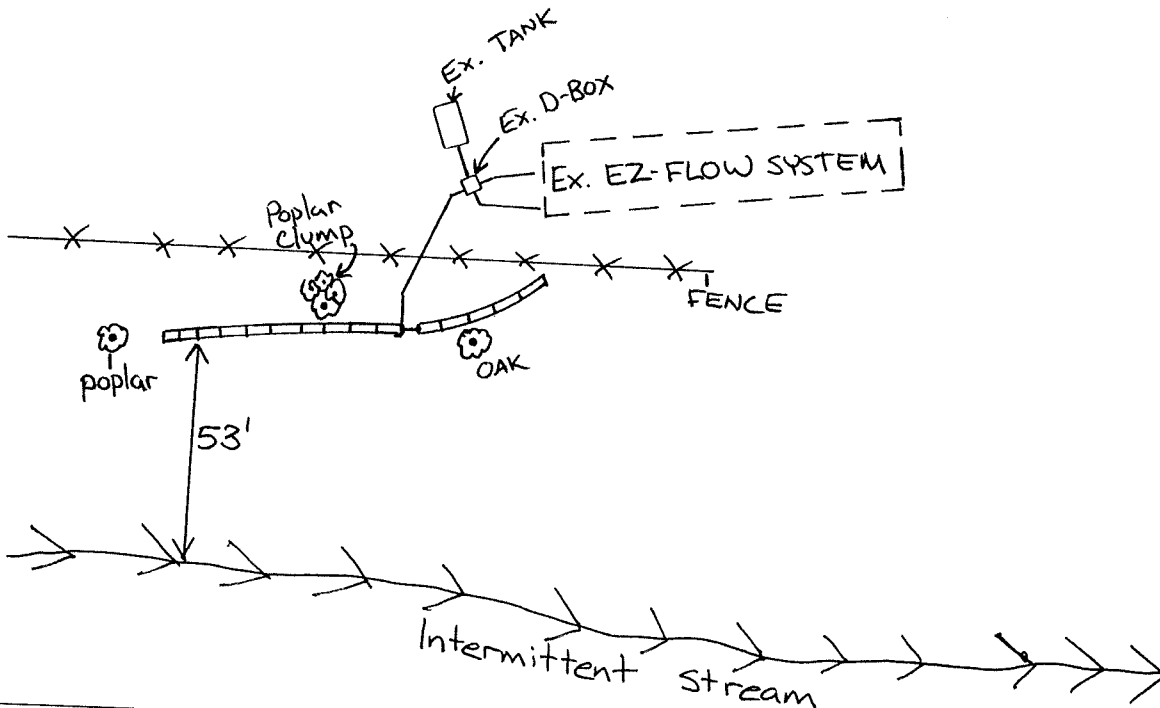

Conditions/Comments: Had existing 2BR EZ-FLOW system and added a 60' Infiltrator chamber (Quick 4) line for a 3BR total system

Subsurface system operator required? No X Yes If yes, see attached sheet for additional operation conditions, maintenance and reporting.

The septic tank should have all compartments pumped out every 3-5 years, on average, or when the solids are more than 1/3 of the liquid depth in any compartment. Depending upon trench depth, maximum fill over the drainfield cannot exceed two feet. Establish cover over drainfield and divert surface waters to prevent erosion or degradation of the system. No part of the septic system should be subjected to: traffic or any other compaction; vegetation with aggressive and/or hydrophilic (water loving) root systems such as maples or willows; excessive fill or heavy landscaping materials such as rocks/boulders; or any other activities or circumstances that may alter site conditions and may cause problems with the initial system or the repair area as permitted.

TRANSYLVANIA COUNTY DEPARTMENT OF PUBLIC HEALTH IMPROVEMENT PERMIT DIAGRAM

File Name: Tom Houldsworth

Permit No.: 10-080

PIN: 8583-76-8316-000

Still Woods Lot 4

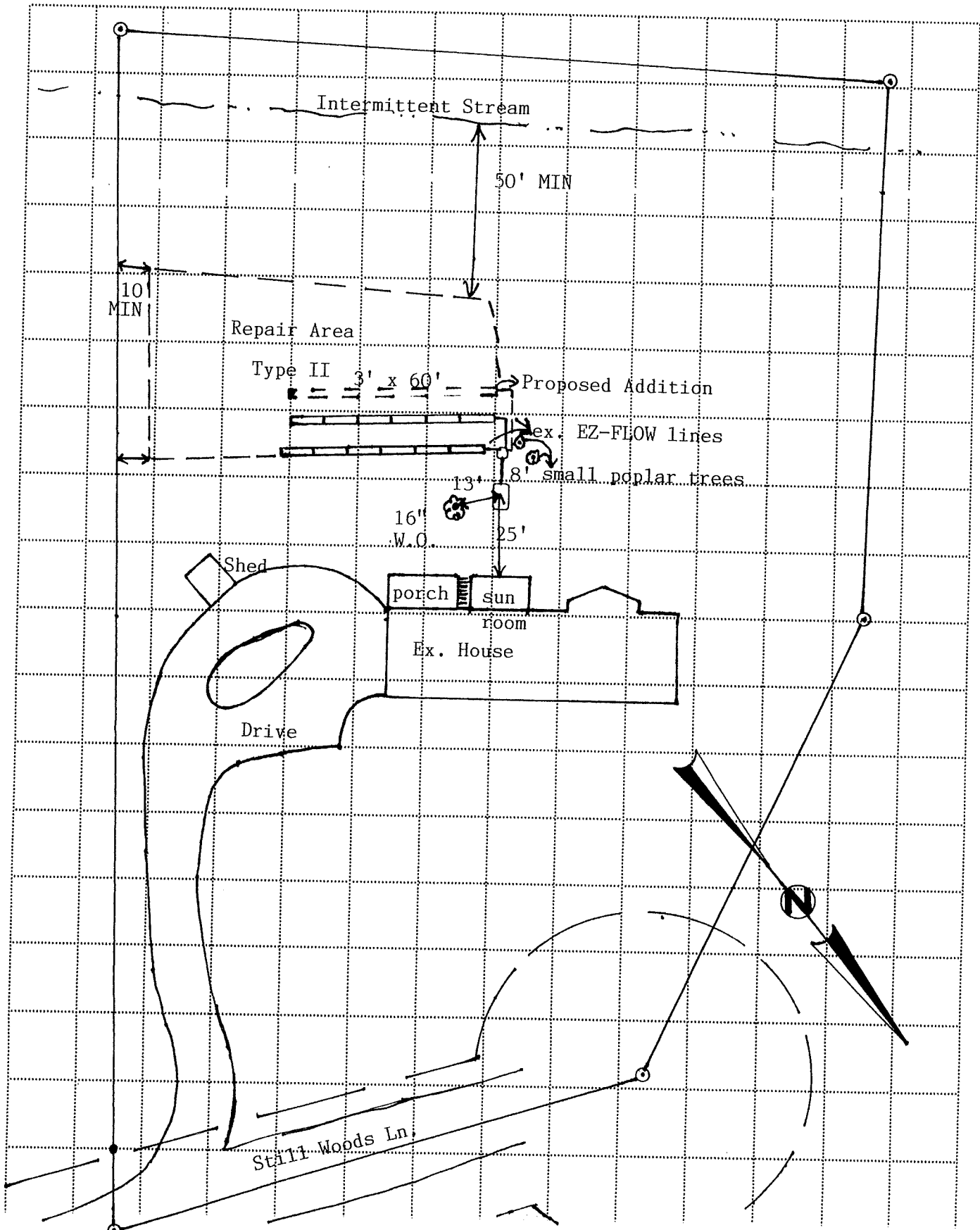

SCALE: 1" = 40'

AS BUILT  
Quick 4 Infiltrator  
Installed  
6/25/2010

need to see supply line  
from d box to new line,  
speed levelers, and connection  
to new line. done KOC 6/25/2010

