

Plat File 13 Slide 144

NCGS (NAD 83/1986) TIES FROM NCGS MONUMENT "HALLELUJAH" TO EACH OF THE INDIVIDUAL UNITS with FINISH FLOOR ELEV and CEILING ELEV

Course	Bearing	Distance	Unit #	Finish Floor Elev	Ceiling Elev
Ⓐ	N33°40'19"E	992.39'	402 Upper Floor	2214.67'	2225.67'
Ⓑ	N34°04'52"E	1194.15'	410 Upper Floor	2214.67'	2226.83'

(CEILING ELEVATIONS PROVIDED BY BUILDER/OWNER SCOTT LAPELL)

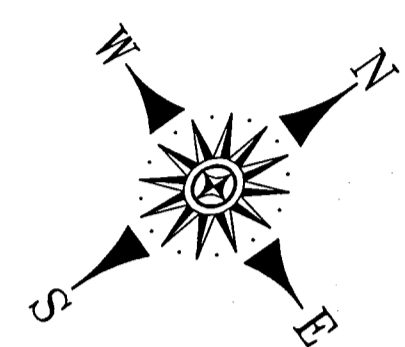

NCGS NORTH NAD 83/1986

ARCHITECT STATEMENT

- 1) THESE DRAWINGS ARE BASED IN PART UPON THE REPRESENTATIONS OF OTHERS AND ARE NOT FOR BIDDING, CONSTRUCTION OR PERMITTING PURPOSES.
- 2) BASE BUILDING PLANS ARE COPIED FROM CONSTRUCTION DOCUMENTS PREPARED AS PART OF BASE BUILDING CONSTRUCTION BY CALLOWAY JOHNSON, MOORE & WEST, ARCHITECTS OF RECORD.
- 3) I HEREBY CERTIFY THAT THESE PLANS FULLY AND ACCURATELY DEPICT THE LAYOUT, LOCATION, FLOOR ELEVATIONS, UNIT NUMBERS, AND DIMENSIONS OF THE UNITS AS BUILT.

LEGEND:

- ELEV ELEVATION
- S.F. SQUARE FEET
- LIMITED COMMON ELEMENT (LCE)

2009003272

TRANSLYVANIA CO, NC FEE \$21.00
 PRESERVED & RECORDED:
 06-10-2009 04:33:39 PM
 CINDY M OWNBEY
 REGISTER OF DEEDS
 BY: TERESA D MORTON
 DEPUTY REGISTER OF DEEDS
 PF 13
 PG:144-144

DOUGLAS K. HARRIS
 REGISTERED ARCHITECT 7999

5.14.09
DATE



WITNESS MY ORIGINAL SIGNATURE, LICENSE NUMBER, AND SEAL THIS THE 18 DAY OF May, 2009

ROBERT L. HAFLER
 PROFESSIONAL LAND SURVEYOR
 L-2975

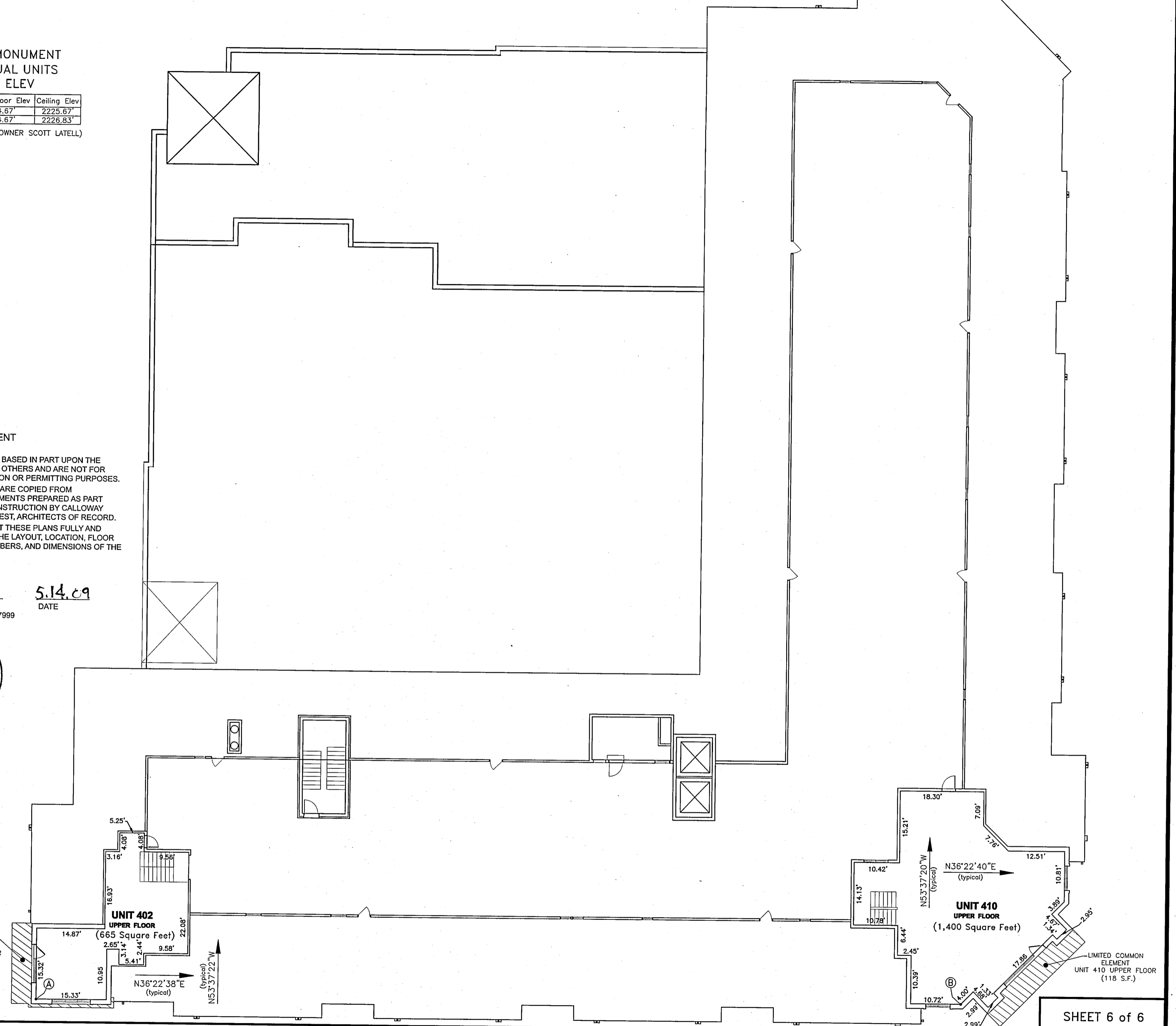
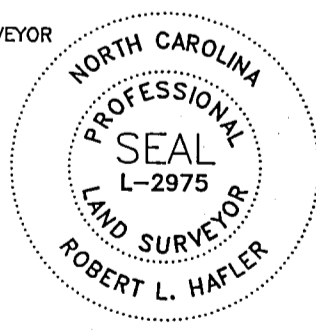

LIMITED COMMON ELEMENT UNIT 402 UPPER FLOOR (90 S.F.)

LIMITED COMMON ELEMENT UNIT 410 UPPER FLOOR (118 S.F.)

PREPARED BY
HAFLER LAND SURVEYING
 435 S. CALDWELL STREET
 BREVARD, NORTH CAROLINA 28712
 (828) 884-7168
 FAX (828) 884-8646



Property Situate in
 CITY OF BREVARD
 BREVARD TOWNSHIP
 TRANSLYVANIA COUNTY
 NORTH CAROLINA

FINAL PLAT
 of the
FRENCH BROAD PLACE
 CONDOMINIUMS (5th Floor)

DATE
 Revised: April 20, 2009
 MARCH 31, 2009

FIELD RECORDS
 DATA COLLECTOR

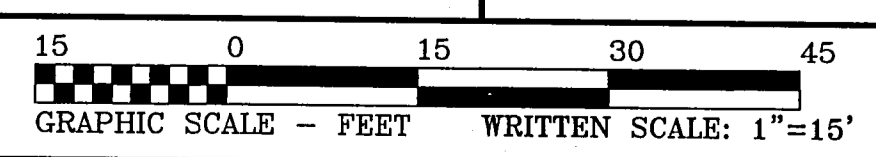

SHEET 6 of 6
 DRAWING
 5th FLOOR HLS CondoDocs
 COORDINATE FILE
 PN07003.crd
 PROJECT NUMBER
 PN09004