

# SKETCH/AREA TABLE ADDENDUM

## SUBJECT INFO

File No.: 01222020      Parcel No.: 8583-72-6163-000  
 Property Address: 744 Dotsi Drive  
 City: Brevard      County: Transylvania      State: NC      ZipCode: 28712  
 Owner: Hilbelink, Don/Amy  
 Client: Deborah Betts, Broker, Looking Glass Realty      Client Address: 5388 Greenville Hwy, Brevard, NC 29812  
 Appraiser Name: RE Broker: Diane L. Jetton, HMS (828)553-0171      Inspection Date: 01/22/2020

## SKETCH

### APPROXIMATE HEATED LIVING AREA

First Floor = 2149 SF  
 Below Grade = 1161 SF  
**TOTAL = 3310 SF**

### OTHER AREAS

Garage = 622 SF  
 Porch = 104 SF  
 Scr. Porch = 210 SF  
 Deck = 180 SF

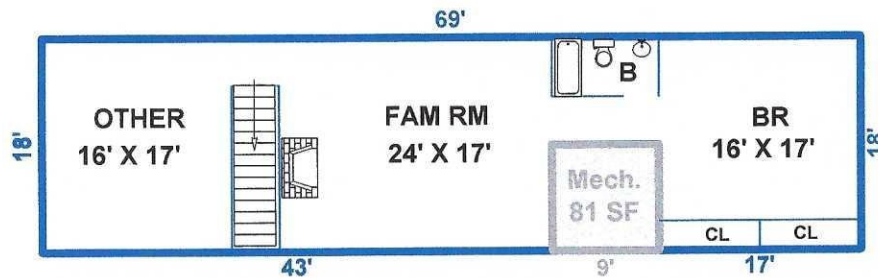
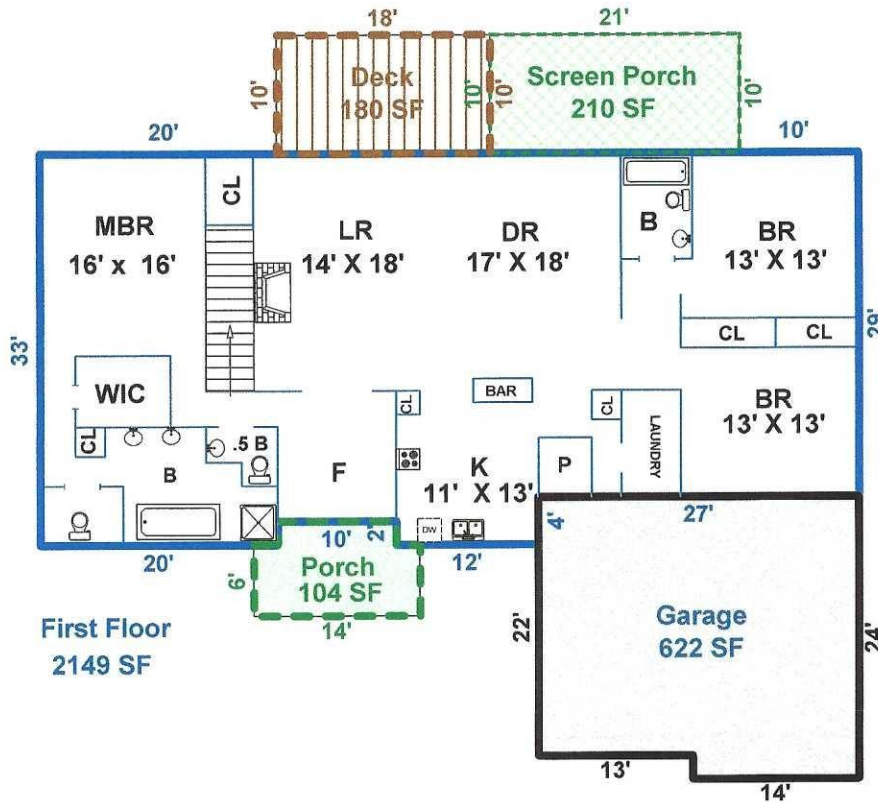

**Heated Living Area Below Grade**  
 1161 SF

NCREC SF Guidelines permit reporting SF as the total living area without splitting above and below grade SF. Therefore, total living area may be reflected differently by appraisers, lenders, and the NC Building Code. SF calculations follow ANSI Standards and NCREC Guidelines (which are used in this report) and are rounded to the nearest foot. Interior sketches are for illustration purposes only.