

PROPERTY LINE TABLE:

Course	Bearing	Distance
L1	N 30°50'01"E	21.00'
L2	N 73°52'27"E	18.00'

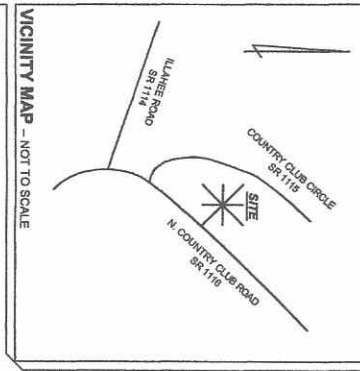

NOTES:

- (1) DEED & PLAT REFERENCES:
(a) DEED BOOK 204, PAGE 918: NELS & MARJORIE GLENE, GRANTEES
(b) DEED BOOK 204, PAGE 918: NELS & MARJORIE GLENE, GRANTEES
(c) DEED BOOK 417, PAGE 381: NELS & MARJORIE GLENE, GRANTEES
(d) DEED BOOK 417, PAGE 381: NELS & MARJORIE GLENE, GRANTEES
(e) DEED BOOK 417, PAGE 381: NELS & MARJORIE GLENE, GRANTEES
(f) DEED BOOK 417, PAGE 381: NELS & MARJORIE GLENE, GRANTEES
(g) DEED BOOK 417, PAGE 381: NELS & MARJORIE GLENE, GRANTEES
(h) DEED BOOK 417, PAGE 381: NELS & MARJORIE GLENE, GRANTEES
(i) DEED BOOK 417, PAGE 381: NELS & MARJORIE GLENE, GRANTEES
(j) DEED BOOK 417, PAGE 381: NELS & MARJORIE GLENE, GRANTEES
- (2) THIS PROPERTY IS SUBJECT TO ALL RIGHTS OF WAY, EASEMENTS, COVENANTS, AND RESTRICTIONS OF RECORD AND NOT OF RECORD.
- (3) ABBREVIATIONS:
IRB = IRON REBAR SET
IPF = IRON PIPE FOUND
C/MF = CONCRETE MONUMENT FOUND
IPF/C/MF = IRON PIPE IN CONCRETE MONUMENT FOUND
IPF/C/MF = IRON PIPE IN CONCRETE MONUMENT FOUND
IPF/C/MF = IRON PIPE IN CONCRETE MONUMENT FOUND
IPF/C/MF = IRON PIPE IN CONCRETE MONUMENT FOUND
IPF/C/MF = IRON PIPE IN CONCRETE MONUMENT FOUND
IPF/C/MF = IRON PIPE IN CONCRETE MONUMENT FOUND
IPF/C/MF = IRON PIPE IN CONCRETE MONUMENT FOUND
IPF/C/MF = IRON PIPE IN CONCRETE MONUMENT FOUND
IPF/C/MF = IRON PIPE IN CONCRETE MONUMENT FOUND
- (4) LOT NUMBERS REFER TO PLAT OF "MONTICLOVE ESTATES" (SEE NOTE 1b).
- (5) AREAS:
"A": COMBINATION OF LOTS 51 & 52 AND A PORTION OF THE GLENE CIRCLE LOTS.
"B": LOT 52 (A PORTION OF THE GLENE CIRCLE LOTS).
"C": THE REMAINDER OF THE GLENE CIRCLE LOTS DESCRIBED IN D.B. 417, PG. 381: 0.384 ACRES MORE OR LESS.
- (6) THERE ARE NO V.C. GEOGRAPHIC CONTROL MONUMENTS WITHIN 2000' OF THIS PROPERTY.

STATE OF NORTH CAROLINA COUNTY OF TRANSYLVANIA

I, DAN H. COLLIER, CERTIFY THAT THIS PLAT WAS DRAWN BY ME FROM AN ORIGINAL SURVEY MADE BY ME OR UNDER MY CLOSE PERSONAL SUPERVISION AND THAT THE BOUNDARY LINES SHOWN ON THIS PLAT ARE TRUE AND CORRECT. I HAVE BEEN DULY QUALIFIED BY THE BOARD OF SURVEYING AND MAPS OF THE STATE OF NORTH CAROLINA TO BE A PROFESSIONAL LAND SURVEYOR. I HAVE BEEN DULY LICENSED BY THE BOARD OF SURVEYING AND MAPS OF THE STATE OF NORTH CAROLINA TO BE A PROFESSIONAL LAND SURVEYOR. I HAVE BEEN DULY LICENSED BY THE BOARD OF SURVEYING AND MAPS OF THE STATE OF NORTH CAROLINA TO BE A PROFESSIONAL LAND SURVEYOR. I HAVE BEEN DULY LICENSED BY THE BOARD OF SURVEYING AND MAPS OF THE STATE OF NORTH CAROLINA TO BE A PROFESSIONAL LAND SURVEYOR.

DATE: November 02, 2005

PROFESSIONAL LAND SURVEYOR REGISTRATION NUMBER: 12592



STATE OF NORTH CAROLINA COUNTY OF TRANSYLVANIA

FILED FOR REGISTRATION ON THE DAY OF 2005.

AT M AND RECORDED IN PLAT # SLIDE

BY: REGISTER OF DEEDS

DEPUTY

STATE OF NORTH CAROLINA COUNTY OF TRANSYLVANIA

FILED FOR REGISTRATION ON THE DAY OF 2005.

AT M AND RECORDED IN PLAT # SLIDE

BY: REGISTER OF DEEDS

DEPUTY

STATE OF NORTH CAROLINA COUNTY OF TRANSYLVANIA

FILED FOR REGISTRATION ON THE DAY OF 2005.

AT M AND RECORDED IN PLAT # SLIDE

BY: REGISTER OF DEEDS

DEPUTY

DAN H. COLLIER
Professional Land Surveyor
24 West Jordan Street - Suite 10
Brevard, North Carolina 28712
828.883.2962

DATE
November 02, 2005

REVISIONS

TOWNSHIP
Brevard

STATE
North Carolina

COUNTY
Transylvania

TAX ID
8565-21-2028-000
8565-21-2188-000
8565-21-3235-000
8565-21-1210-000

ZONING
R-1

HORIZONTAL SCALE
1" = 30'

JOB NUMBER
051102

SURVEY FOR:
JAMES SKALA
and wife **LORRAINE SKALA**

BEING A COMBINATION OF PARCELS (TRACT "A" AS SHOWN) AND A RESURVEY OF AN EXISTING PARCEL (TRACT "B" AS SHOWN)

