

3 CRESTVIEW CT., ARDEN, NC 28704

APPROXIMATE TOTAL HEATED LIVING AREA

(Above/Below Grade) = 2,253 SF

First Floor = 1,591 SF

Below Grade = 662 SF

APPROXIMATE UNHEATED AREA

Unfinished Basement = 836 SF

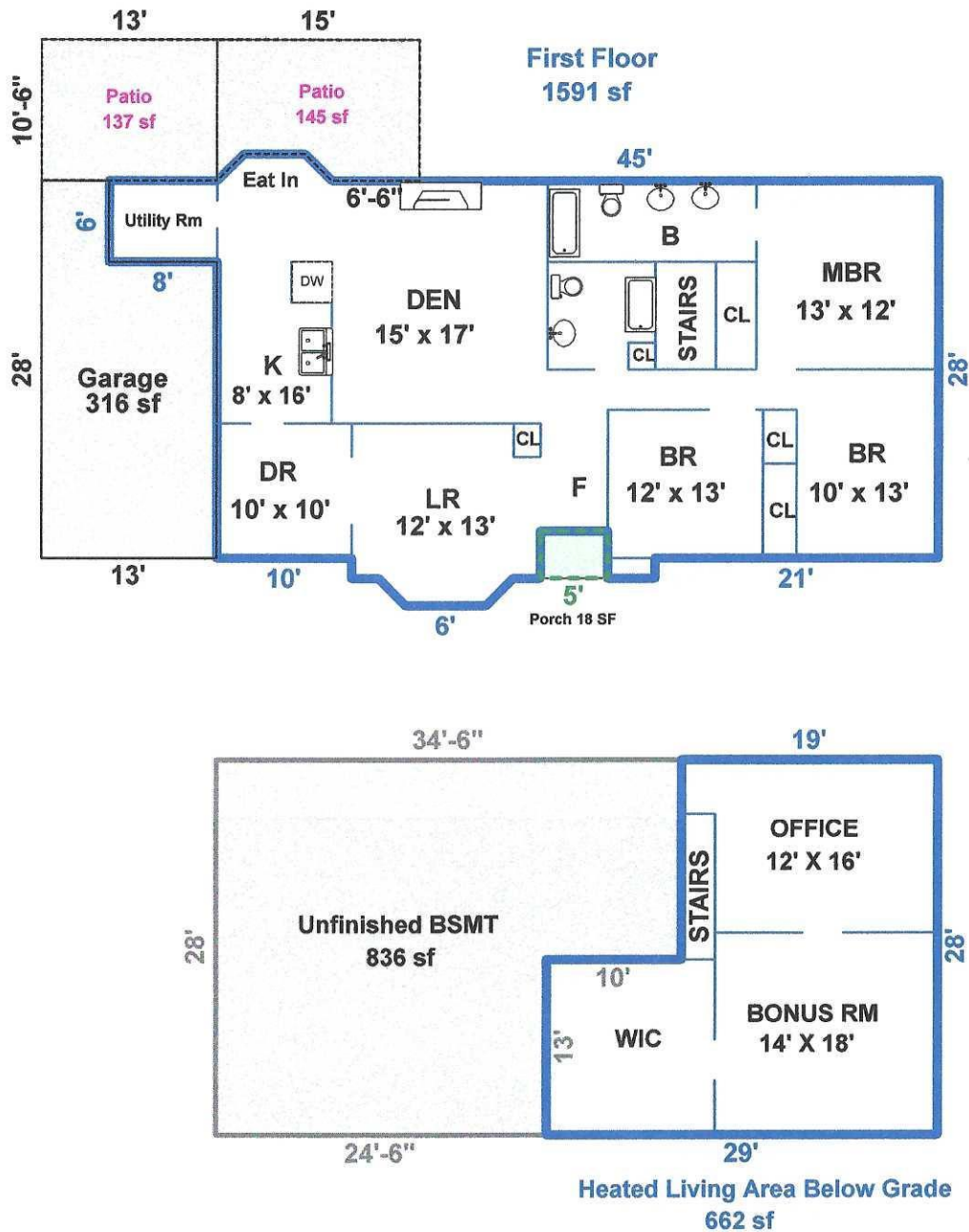

NCREC SF Guidelines permit reporting SF as the total living area without splitting above and below grade SF. Therefore, total living area may be reflected differently by appraisers, lenders, and the NC Building Code. SF calculations follow ANSI Standards and NCREC Guidelines (which are used in this report). Interior sketches are for illustration purposes only and are rounded to the nearest half foot.