

STATE OF NORTH CAROLINA
COUNTY OF BUNCOMBE

THE FOREGOING CERTIFICATE OF Vivian J. Gaddy, A NOTARY PUBLIC OF THE STATE AND COUNTY DESIGNATED, IS CERTIFIED, TO BE CORRECT THIS 22 DAY OF October, 1982, Chris R. Smith, Jr., REGISTER OF DEEDS, BUNCOMBE COUNTY, BY: Chris R. Smith, Jr., DEPUTY.

FILED FOR REGISTRATION ON THE 22 DAY OF October, 1982, Chris R. Smith, Jr., REGISTER OF DEEDS, BUNCOMBE COUNTY, BY: Chris R. Smith, Jr., DEPUTY.

I, CHRIS R. SMITH, JR., CERTIFY THAT UNDER MY DIRECTION AND SUPERVISION THIS MAP WAS DRAWN FROM AN ACTUAL FIELD LAND SURVEY; THAT THE ERROR OF CLOSURE OF THE CONTROL SURVEY AS CALCULATED BY LATITUDES AND DEPARTURES DOES NOT EXCEED 1:10,000; THAT THIS MAP WAS PREPARED IN ACCORDANCE WITH GS 47-30 AS AMENDED.

WITNESS MY HAND AND SEAL THIS 22 DAY OF OCTOBER, 1982 A.D.

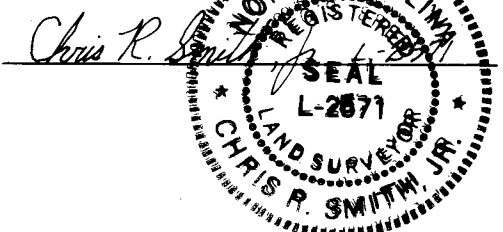

STATE OF NORTH CAROLINA
COUNTY OF BUNCOMBE

I, VIVIAN J. GADDY, A NOTARY PUBLIC OF SAID STATE AND COUNTY, DO HEREBY CERTIFY THAT CHRIS R. SMITH, JR. PERSONALLY APPEARED BEFORE ME THIS DAY AND ACKNOWLEDGED THE DUE EXECUTION OF THE FOREGOING INSTRUMENT.

WITNESS MY HAND AND NOTARIAL SEAL THIS THE 22 DAY OF OCTOBER, 1982.

Vivian J. Gaddy
NOTARY PUBLIC

MY COMMISSION EXPIRES: 3/10/87

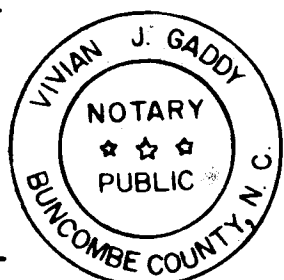

PROPOSED BOUNDARY DESCRIPTION
FOR
WOODFIELD - SECTION 1

A parcel or tract of land located in Biltmore Township, Buncombe County, North Carolina and being described as follows with the basis of bearings from a true meridian determined by solar observations:

BEGINNING at a 1-inch iron pin in the northern edge of pavement of U. S. Highway No. 74 and being designated as the southwest corner of the W. P. Moore tract, recorded in Deed Book 612 at Page 585 in the Buncombe County Registry, and also being in the line of Harvey L. and Gayle C. Huntley property, recorded in Deed Book 1185 at Page 115 in said registry; thence from said beginning point and along said northern edge of pavement and said Huntley line North 62° 58' 50" West 234.27 feet to a point; thence North 61° 49' 10" West 86.83 feet to a spike set in said northern edge of pavement and said Huntley line; thence leaving said highway and Huntley line North 31° 12' 40" East 75.49 feet to an iron pin; thence North 09° 49' 30" East 89.47 feet to an iron pin; thence North 01° 42' 10" West 50.35 feet to an iron pin; thence South 66° 04' 10" East 125.41 feet to an iron pin; thence South 86° 37' 30" East 253.08 feet to a bolt set in a paved driveway in a line claimed as the western line of the W. P. Moore tract; thence with said line South 25° 21' 20" West 315.06 feet to the point of BEGINNING and containing 1.871 acres. This tract is subject to easements and rights-of-way of record.

- LEGEND
- Right-of-way or easement line
 - Unmarked point
 - Existing spike at northern edge of pavement
 - Found iron pin
 - I.P.S. - Existing 1" iron pin
 - E.I.P. - Existing 1" iron pin
 - Utility Pole
 - Fence remains
 - Storm drain
 - Existing underground telephone cable (approximate location)
 - N.T.S. - Not to scale
 - Water Meter
 - Power Transformer
 - Catch Basin
 - Water Line
 - Existing Sanitary Sewer
 - Stream

SECTION 1 = 1.871 Acres
FUTURE DEVELOPMENT = 13.169 Acres
TOTAL AREA = 15.040 Acres
EXCLUDING OVERLAPS

Revision: 10/19/82. Revised proposed 20' utility easement location. Added proposed sanitary sewer easements. Added as-built locations.

Woodfield

SECTION 1

OWNER AND DEVELOPER

POINT SOUTH INVESTMENT CO., INC.

BILTMORE TOWNSHIP

BUNCOMBE COUNTY

NORTH CAROLINA

REF. = D.B. 1266 PG. 18 & D.B. 1291 PG. 297

CHRIS R. SMITH, R.L.S. - ASHEVILLE, N.C.

SCALE: 1" = 60'

DATE: AUGUST 12, 1982

