

HENDERSON COUNTY HEALTH DEPARTMENT

Completion Permit

New Construction   
Repair   
Pre-Existing Tank

Permit Number

C No. 10183

I No. 11538

Owner Clara Moss Date 11 April 88

Building Contractor " "

Septic Tank Installer Morgan Landscaping

Location 61 to Blantyre to River Rd to Pleasant Ground

Lot No. 1st entrance to side on left Development Indian Ridge

House  Mobile Home  Other

No. Bedrooms 3

Basement Plumbing Yes  No

Water Supply - Community  Individual  City

Lot Size 6+ ac

Tank Size 1000 Drain Field 723 Sq. Ft.

Stone Depth 12 Inches

Valid only for use as described above.

Zoning regulations may be in effect in your area, before proceeding with construction, check with the Henderson County Zoning Officer or Inspection Department.

Received by Jack Laps Approved for Material & Workmanship Only

Issued by Joe H. Dinger BS Sanitarian

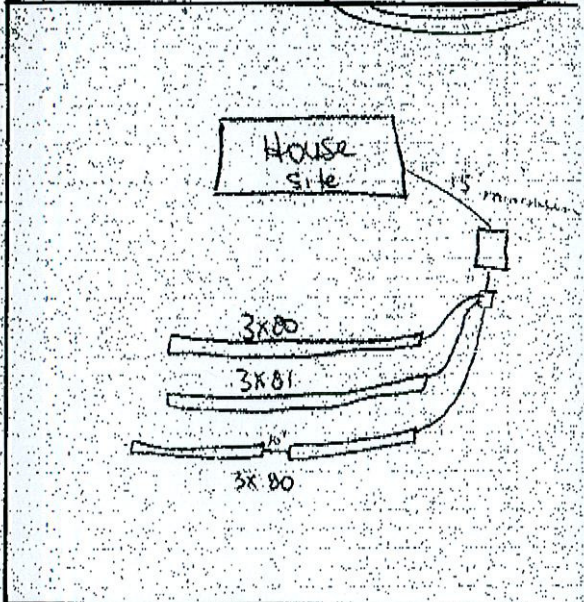

Pl. 502

# Henderson County Health Department

1347 SPARTANBURG HIGHWAY  
HENDERSONVILLE, NORTH CAROLINA 28739  
TELEPHONE: 704/692-4228

## APPLICATION FOR LOT EVALUATION FOR SUB-SURFACE SEWAGE DISPOSAL

Construction is not to begin until a building permit has been issued!

Before an inspection can be made, a copy of survey plat must be on file with the Health Department.  
Corners of the property and proposed constructions must be clearly staked.

1. Permit Requested By Clara Mae Moss Bus. Ph. #2855-2880 Home Ph. #84-3403  
Address #84 Carolina Ave

2. Current Owner's Name & Address \_\_\_\_\_

3. Subdivision or Mobile Home Park Name Indian Ridge Lot # 6

4. Date Lot Originally Platted 1-13-87

5. System will be used to serve what type of facility:  
House  Mobile Home \_\_\_\_\_ Business \_\_\_\_\_ Industry \_\_\_\_\_ Other \_\_\_\_\_

6. If house or mobile home, state size: Dimensions: \_\_\_\_\_

Number of: Bedrooms 3 Den with Closet No Basement: Yes  No \_\_\_\_\_

Water using fixtures in basement? Yes  No \_\_\_\_\_

7. Property dimensions: Total square footage or acreage 6.15 Acres Width \_\_\_\_\_ Depth \_\_\_\_\_

8. Do you anticipate any additions or expansions of the facility this sewage system is intended to serve?  
Yes \_\_\_\_\_ No  What type? \_\_\_\_\_

9. Type of water supply? City \_\_\_\_\_

Individual (well or spring serving one family)

Community (well or spring serving more than one family) \_\_\_\_\_

10. If business, industry or other state: Number of employees: \_\_\_\_\_

11. DIRECTIONS TO PROPERTY (give road numbers and names) Hwy 64 west to County Line, turn Left At first road cross bridge go to end, turn Left Again go about 2 miles to large Church on left then turn Right on dirt Road go 2 miles to Indian Ridge Sign turn Right.

I certify the above to be correct to the best of my knowledge and permission is hereby granted to perform a soils evaluation on the property described above.

3-27-87  
Date

Clara Mae Moss  
Signature

