

PIN: 8597-46-3093-000

File Name: Pisgah Forest Outlook, LLC

Permit No.: 16-042

TRANSYLVANIA COUNTY DEPARTMENT OF PUBLIC HEALTH

Improvement Permit

A building permit cannot be issued with only an Improvement Permit

ISSUED TO: Pisgah Forest Outlook, LLC

PROPERTY LOCATION: 115 Mama's Place

New [X] Repair [] Expansion []
Type of Structure: Single Family Residence
Proposed Wastewater System Type: II
Projected Daily Flow: 360 GPD
Number of bedrooms: 3 Max. No. of Occupants: 6

Site Improvements required prior to Construction Authorization Issuance: n/a

Pump Required: [] Yes [X] No [] May be required based upon final location and elevations of facilities

Pump systems with an effluent pump must be designed by a Professional Engineer (P.E.) and plans submitted to the Environmental Health Section for approval.

Type of Water Supply: Public

Improvement Permit Expiration Date: 3/21/2021

Permit conditions: See Permit Diagram

Authorized State Agent: Heillo. Cary REHS

Date: 3/21/2016

See Attached Permit Diagram

The issuance of this permit by the Transylvania County Environmental Health Section in no way guarantees the issuance of other permits. The permit holder is responsible for checking with appropriate governing bodies in meeting their requirements. This permit is subject to revocation if the site plan, plat, or the intended use changes. The Improvement Permit shall not be affected by a change in ownership of the site. This permit is subject to compliance with the provisions of the Laws and Rules for Sewage Treatment and Disposal and to conditions of this permit.

Construction Authorization (Required for Building Permit)

Septic System to be installed by a Certified Installer

The construction and installation requirements of Rules .1950, .1952, .1954, .1955, .1956, .1957, .1958, and .1959 are incorporated by reference into this permit and shall be met. Systems shall be installed in accordance with the attached system layout.

ISSUED TO: Pisgah Forest Outlook, LLC

Type of Structure: Single Family Residence

Basement? [X] Yes [] No

[] No

Basement Plumbing Fixtures? [X] Yes [] No

[X] Yes

[] No

Type of Wastewater System** (See note below, if applicable [])

25% Reduction (Initial)

Wastewater Flow: 360 GPD

Same (Repair)

LTAR: 0.45

Installation Requirements/Conditions

Septic Tank Size: 1000 gallons, minimum

Total Trench Length: 200 feet

Trench Spacing: 9 Feet on Center

Pump Tank Size n/a gallons, minimum

Trench Width: 3 feet

Distribution Method: d-box/serial feed

Trenches shall be installed on contour at a maximum trench depth of: 24 inches. There shall be a minimum of 6" of soil cover over the installed drainfield material and the bottom of the trench shall not be greater than 36" from the surface of the ground at final grade.

(Trench bottoms shall be level to +/- 1/4" in all directions)

Min. distance between system and nearest: Well 100 ft. Water Line 10 ft Foundation 5 ft Property Line 10 ft Vertical Cut 15 ft

Permit Conditions: Use trench depth straighten drainlines and work through slight contour problems. Call with any questions or concerns. (828) 884-3139

**If applicable:

I understand the system type specified is different from the type specified on the application. I accept the specifications of this permit.

Owner/Legal Representative Signature: [Signature]

Date: 3/21/2016

This Construction Authorization is subject to revocation if the site plan, plat, or the intended use changes. The Construction Authorization shall not be transferred when there is a change in ownership of the site. This Construction Authorization is subject to compliance with the provisions of the Laws and Rules for Sewage Treatment and Disposal and to the conditions of this permit. I agree to have the on-site wastewater system installed by an authorized installer in accordance with the Improvement Permit, Construction Authorization, permit diagram and any conditions specified therein.

Authorized State Agent: Heillo. Cary REHS

Date of Issuance: 3/21/2016

See Attached Permit Diagram

Construction Authorization Expiration Date: 3/21/2021

File Name: Pisgah Forest Outlook LLC Permit No.: 16-042 PIN: 8597-46-3093-000

(115 Mama's Place)

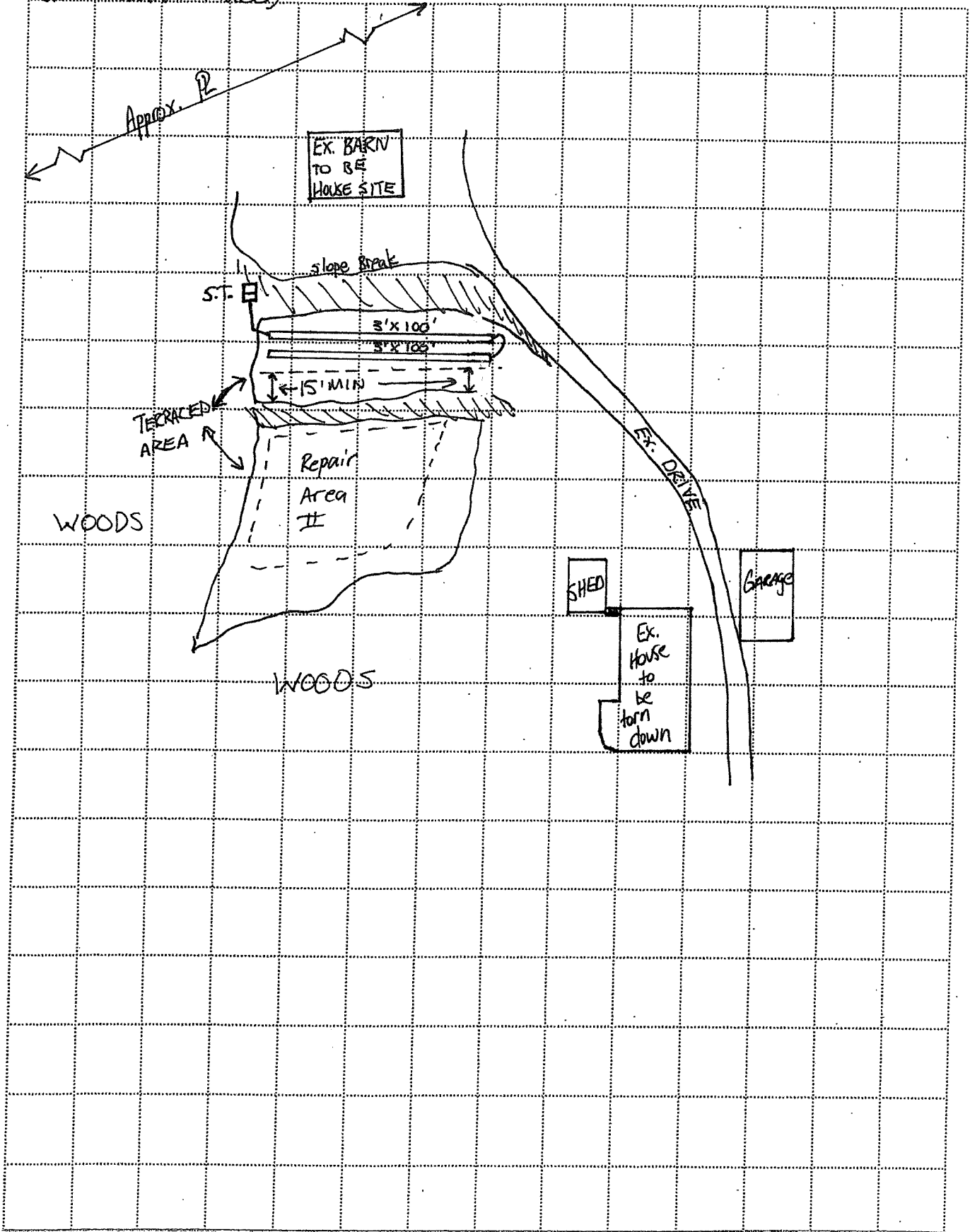

SCALE: 1" = 60'