

RICHLAND RIDGE

TRANSYLVANIA COUNTY HEALTH DEPARTMENT  
ON-SITE WASTEWATER DISPOSAL APPLICATION

Pin #/Tax ID 8533-66-7613-000

Receipt No 08654 \$75.00

File Name:

Permit #: 98-425

Agent/Owner: RICHLAND RIDGE PARTNERSHIP

Mailing Address: 33 West Main St. Brevard, NC

Home Phone #: ( ) Mailing Address: 884-6993

Proposed Buyer: Mailing Address:

Home Phone #: ( ) Work Phone #: ( ) 884-6993

Property Location: RICHLAND RIDGE Rd. Subdivision: RICHLAND RIDGE Site 2

Directions to property: Hwy. 64 west - right at Thorpe's store - left on Richland Ridge - take left up

mountain about 1 mile - both sides of road is property - road dead ends.

Flood Zone	
Is the property in a flood zone?	
<input type="checkbox"/> Yes	<input checked="" type="checkbox"/> No
Inspections	
<input type="checkbox"/> Flood Zone	<input type="checkbox"/> No
<input type="checkbox"/> Yes	<input type="checkbox"/> No
<input type="checkbox"/> Approved	<input type="checkbox"/> Disapproved
Initials	Date

Installation for: Mobile Home  Single  Double  House  No. Bedrooms: 4 Basement: Yes  No  With Plumbing: Yes  No  Ind./Commercial  Other

If Indust./Commercial/Other: Number of employees: Operation: (Describe) road/utilities Property contains designated wet lands: Yes  No

Lot size: 252 ac. Date lot recorded: before 1980 Right of ways, easements, etc. Water Supply: Private  Spring  Well  Shared Supply  Public/Community

I certify the above to be correct to the best of my knowledge. Permission is hereby granted to perform a site/soil evaluation on the property described above. If the information submitted in this application is falsified or changed, the permit shall become void. I understand that it is my responsibility as the applicant/agent/owner to comply with all applicable ordinances, laws, and rules from other agencies that may affect the development of this property.

Applicant/Agent Signature: [Signature]

Date: 3-17-98

ON-SITE WASTEWATER DISPOSAL SYSTEM  
OPERATIONS PERMIT

The issuance of this operations permit certifies that the system described on the improvement permit and the construction authorization is properly installed or repaired and that the system is capable of being operated in accordance with the conditions of the improvement permit, Article 11 of Chapter 130A of the General Statutes of North Carolina and the rules adopted pursuant to this Article. This operation permit shall remain in effect as long as the system is operated and maintained as required by the Laws and Rules for Sewage Treatment and Disposal Systems as issued by the North Carolina Department of Environment and Natural Resources, Division of Environmental Health.

System Classification Type: II Management Entity:  Owner  Certified Operator Minimum inspection/maintenance review frequency \_\_\_\_\_ years.

Comments: (3) 70' Blvd. Fuser (partial inspection 9-8-03; no D-box & solid ppgs; need all end caps; close gaps between some chambers, S.T. vent open [corrected]) AS + NC

Installed by: Ernie McCall per Scott Moser Final Inspection by: [Signature] RS Date: 12.3.03

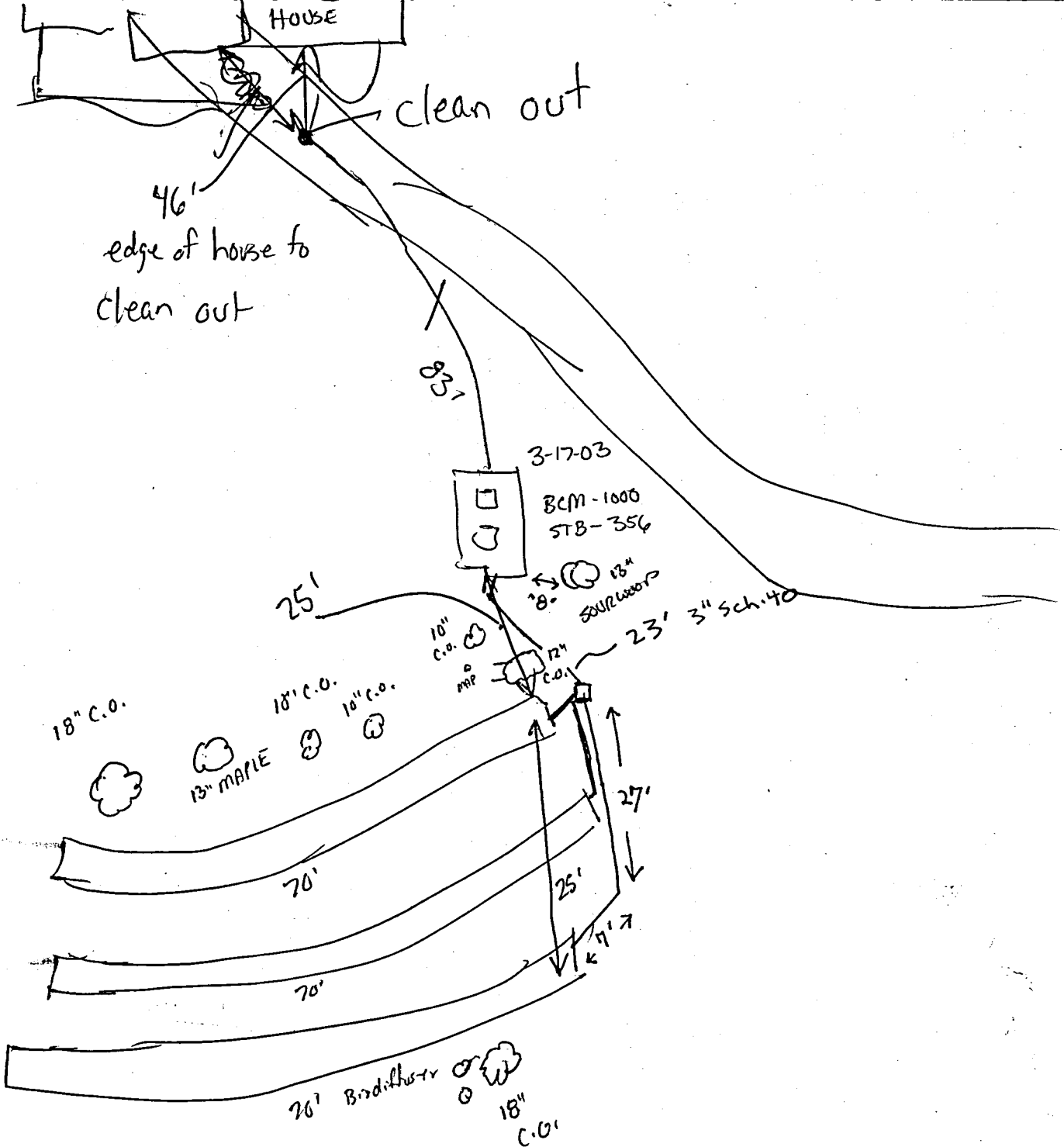

9-8-03 partial inspection - no D-box/pipins; need end caps, gaps between chambers, open s.t. vent

File Name: RICHLAND RIDGE TRANSYLVANIA COUNTY HEALTH DEPARTMENT  
 98-425 ON-SITE WASTEWATER DISPOSAL APPLICATION  
 Permit #: RICHLAND RIDGE PARTNERSHIP  
 Agent/Owner: \_\_\_\_\_ Mailing Address: 33 West Main St. Bravard, NC  
 Home Phone #: \_\_\_\_\_ Work Phone #: 884-6993  
 Proposed Buyer: \_\_\_\_\_ Mailing Address: \_\_\_\_\_  
 Home Phone #: \_\_\_\_\_ Work Phone #: \_\_\_\_\_  
 Property Location: Richland Ridge Rd. Subdivision: RICHLAND RIDGE Phase/Sec.: \_\_\_\_\_  
 Road/Street Lot #: Site 2  
 Directions to property: Wvy. 64 west - right at Thorpe's store - left on Richland Ridge - take left up  
mountain about 1 mile - both sides of road is property - road dead ends.

Pin #/Tax ID 8533-66-7613-000  
 Receipt No. 08654 \$75.00

Flood Zone	
Is the property in a flood zone?	
<input type="checkbox"/> Yes	<input checked="" type="checkbox"/> No
Inspections	
Flood Zone	
<input type="checkbox"/> Yes	<input type="checkbox"/> No
<input type="checkbox"/> Approved	<input type="checkbox"/> Disapproved
Initials _____	Date _____

Installation for: Mobile Home  Single  Double  House  No. Bedrooms: 4 Basement: Yes  No  With Plumbing: Yes  No  Ind./Commercial  Other   
 If Indust./Commercial/Other: Number of employees: \_\_\_\_\_ Operation: (Describe) \_\_\_\_\_ Property contains designated wet lands: Yes  No   
 Lot size: 252 ac. before 1980 Date lot recorded: \_\_\_\_\_ Right of ways, easements, etc. road/utilities Water Supply: Private  Spring  Well  Shared Supply  Public/Community

I certify the above to be correct to the best of my knowledge. Permission is hereby granted to perform a site/soil evaluation on the property described above. If the information submitted in this application is falsified or changed, the permit shall become void. I understand that it is my responsibility as the applicant/agent/owner to comply with all applicable ordinances, laws, and rules from other agencies that may affect the development of this property.

Applicant/Agent Signature: [Signature] Date: 3-17-98

**AUTHORIZATION FOR WASTEWATER SYSTEM CONSTRUCTION**  
 (Diagram and Conditions Attached)

New Installation:  Repair/Addition:  Original Permittee: \_\_\_\_\_ Dated: \_\_\_\_\_  
 Design waste flow: 450 GPD LTRs 6 Septic Tank Capacity: 1000 gal./min. Pump Tank Capacity: \_\_\_\_\_ gal./min. Proposed Wastewater System: 111WS 97-2  
 Drainfield: Total Trench Length: 210 ft. Square Footage: 840 Trench spacing: 9 on ctr. Individual Trench Length: 70 ft. Maximum Trench Depth (Low Side): 12 in. Trench Width: 36 in.  
 Distribution Method: D-BOX Min. distance between system and nearest Well: 50 ft. Water line: 10 ft. Foundation: 5 ft. Property line: 10 ft. Vertical Cut: 15 ft.  
 Comments & Special Conditions: Drainfield to have 12" min. additional soil cover. Authorization for Construction to be issued after a site review with the builder/owner just prior to Construction.  
 Construction of the wastewater system for the permit indicated is hereby authorized. The wastewater system described in the improvement permit has been designed and can be installed and operated in compliance with Article 11 of Chapter 130A of the General Statutes of North Carolina and Rules adopted pursuant to this Article. This Construction Authorization is valid for a period of 5 years from the original date of issue. The Construction Authorization must be renewed upon expiration prior to the installation/repair of the wastewater system, or prior to the issuance of any required building permits. A pre-construction conference with the owner or developer, or an agent of the owner or developer, and the health department will be required for re-issuance of the Construction Authorization.  
 I agree to install the wastewater disposal system in accordance with the improvement permit, construction authorization and any conditions specified therein.  
 Signed: [Signature] Date: 2.25.03 Construction Authorization prepared by [Signature] Date: 2.19.03  
**PERMIT AND CONSTRUCTION AUTHORIZATION MUST BE ON SITE DURING ALL PHASES OF CONSTRUCTION/INSTALLATION AND INSPECTION**

TRANSYLVANIA COUNTY HEALTH DEPARTMENT IMPROVEMENT PERMIT DIAGRAM

File Name: Richland Ridge

Permit No.: 98-425

Pin No.: 8533 66 7613000

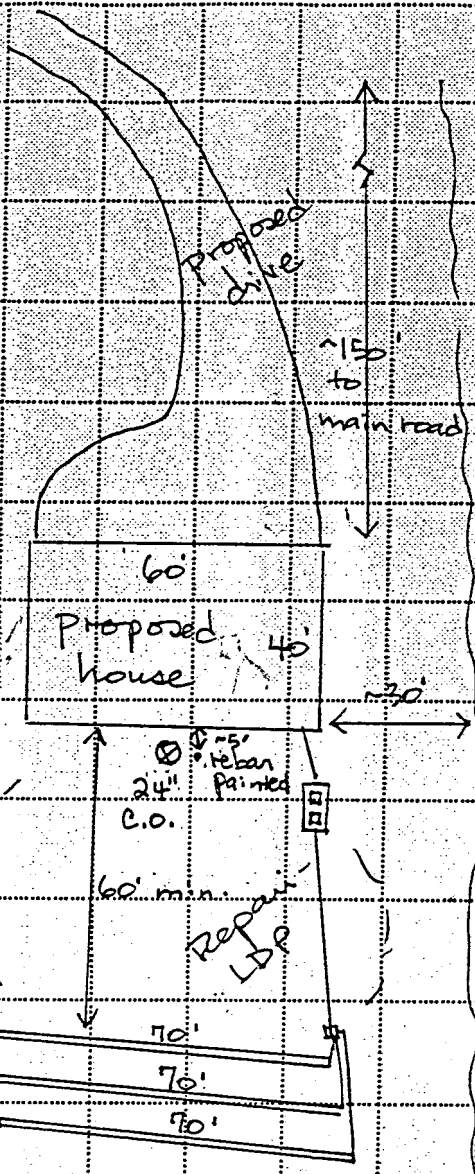

Some shallow rocks

unimproved surface road

Biodifuser

Site 2

Scale 1" = 40'