

Plat File 13 Slide 140

NCGS (NAD 83/1986) TIES FROM NCGS MONUMENT "HALLELUJAH" TO EACH OF THE INDIVIDUAL UNITS with FINISH FLOOR ELEV and CEILING ELEV

Course	Bearing	Distance	Unit #	Finish Floor Elev	Ceiling Elev
Ⓐ	N33°40'19"E	992.39	UNIT 101	2159.25'	2174.83'
Ⓑ	N33°39'41"E	1051.88	UNIT 102	2159.40'	2174.83'
Ⓒ	N33°39'55"E	1095.59	UNIT 103	2158.50'	2174.83'
Ⓓ	N34°04'52"E	1194.15	UNIT 104	2158.50'	2174.83'
Ⓔ	N32°30'03"E	1219.49	UNIT 105	2158.50'	2174.83'
Ⓕ	N26°47'45"E	1226.63	UNIT 106	2159.90'	2174.83'
Ⓖ	N23°38'38"E	1201.01	UNIT 107	2161.65'	2174.83'
Ⓗ	N23°28'55"E	1168.27	UNIT 108	2162.60'	2174.83'

(SEE NOTE #15 REGARDING CEILING ELEVATIONS)

**LEGEND:**

- 3.02'\* ASTERISK DENOTES ADJUSTED DISTANCE (INCOMPLETE WALL CONSTRUCTION)
- ♿ HANDICAP ACCESS
- ⊠ GRANIT PLANTER WITH 3/4" ELECTRICAL CONDUIT
- ⊙ STREET LIGHT
- ⊕ TRANSFORMER PAD
- ▒ BRICK PAVERS
- ▓ CONCRETE SIDEWALK
- ▨ LIMITED COMMON ELEMENT (LCE)

2009003268  
 TRANSYLVANIA CO., NC FEE \$21.00  
 PRESENTED & RECORDED  
 06-10-2009 04:33:35 PM  
 CINDY M OWNBEY  
 REGISTER OF DEEDS  
 BY: TERESA D MORTON  
 DEPUTY REGISTER OF DEEDS  
 PF 13  
 PG:140-140

WITNESS MY ORIGINAL SIGNATURE, LICENSE NUMBER, AND SEAL THIS THE 18 DAY OF May, 2009

Robert L. Hafler  
ROBERT L. HAFLER  
PROFESSIONAL LAND SURVEYOR  
L-2975

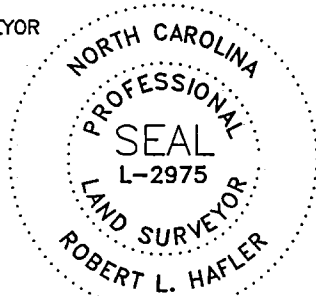

ARCHITECT STATEMENT

- 1) THESE DRAWINGS ARE BASED IN PART UPON THE REPRESENTATIONS OF OTHERS AND ARE NOT FOR BIDDING, CONSTRUCTION OR PERMITTING PURPOSES.
- 2) BASE BUILDING PLANS ARE COPIED FROM CONSTRUCTION DOCUMENTS PREPARED AS PART OF BASE BUILDING CONSTRUCTION BY CALLOWAY JOHNSON, MOORE & WEST, ARCHITECTS OF RECORD.
- 3) I HEREBY CERTIFY THAT THESE PLANS FULLY AND ACCURATELY DEPICT THE LAYOUT, LOCATION, FLOOR ELEVATIONS, UNIT NUMBERS, AND DIMENSIONS OF THE UNITS AS BUILT.

DOUGLAS K. HARRIS  
REGISTERED ARCHITECT 7999

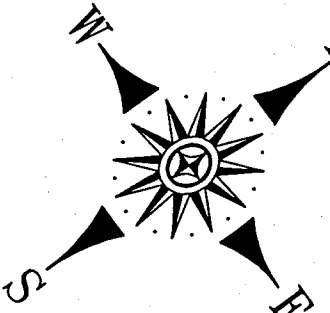
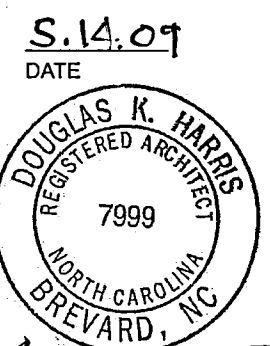

NCGS NORTH  
NAD 83/1986

APPLE TREE STREET EXTENSION

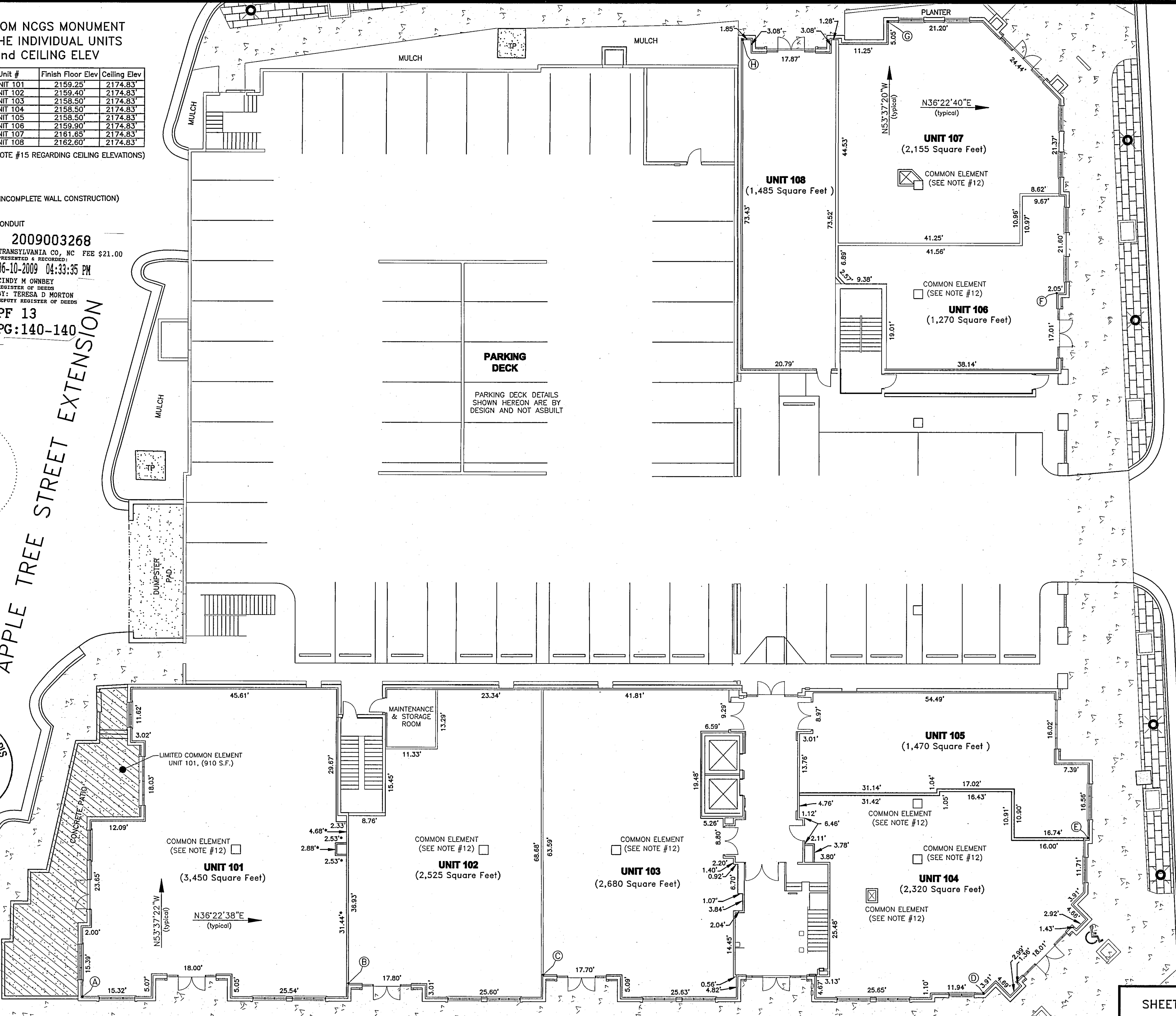

FRENCH BROAD STREET

SHEET 2 of 6

PREPARED BY  
**HAFLER LAND SURVEYING**  
435 S. CALDWELL STREET  
BREVARD, NORTH CAROLINA 28712  
(828) 884-7168  
FAX (828) 884-8646



Property Situate in  
CITY OF BREVARD  
BREVARD TOWNSHIP  
TRANSYLVANIA COUNTY  
NORTH CAROLINA

FINAL PLAT  
of the  
**FRENCH BROAD PLACE**  
CONDOMINIUMS (1st Floor)

DATE  
Revised: April 20, 2009  
MARCH 31, 2009

FIELD RECORDS  
DATA COLLECTOR

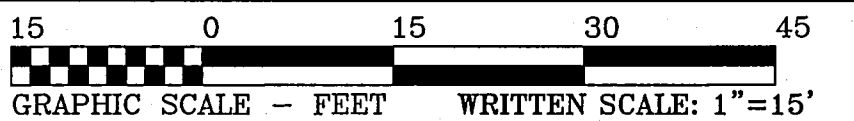

DRAWING  
1st FLOOR HLS CondoDocs

COORDINATE FILE  
PN07003.crd

PROJECT NUMBER  
PN09004