

58 Rainbow's End  
Lake Toxaway, NC

UPPER LEVEL LIVING SPACE:	600 SQ. FT.
MAIN LEVEL LIVING SPACE:	1,093 SQ. FT.
<b>TOTAL HEATED LIVING SPACE:</b>	<b>1,693 SQ. FT.</b>
*UPPER BONUS SPACE:	94 SQ. FT.
SCREENED PORCH:	178 SQ. FT.
COVERED FRONT PORCH:	62 SQ. FT.
COVERED LOWER PORCH:	86 SQ. FT.
WORKSHOP:	167 SQ. FT.
CARPORT:	223 SQ. FT.
<b>TOTAL UNDER ROOF:</b>	<b>2,503 SQ. FT.</b>
OPEN DECKS:	497 SQ. FT.

- HEATED LIVING SPACE
- UNHEATED/UNFINISHED/\*BONUS SPACE
- COVERED PORCH
- UNCOVERED DECK/PATIO

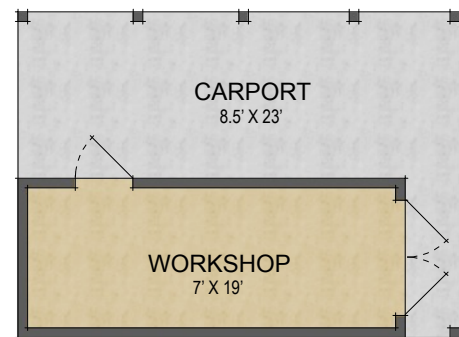

Main Level Floor Plan

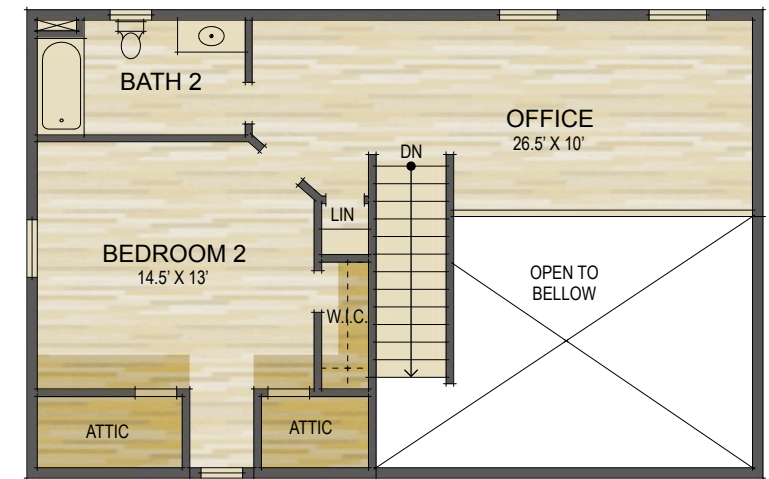

Upper Level Floor Plan

NOTES:  
 \* - LIVING SPACE REQUIRES A MIN. OF 7'-0" CEILING HEIGHT (5'-0" BELOW A SLOPED CEILING, FINISHED SURFACES, HEATED SPACE, & DIRECT CONNECTION WITH OTHER LIVING SPACE. BONUS SPACE SHOWN MEETS SOME BUT NOT ALL OF THESE QUALIFICATIONS  
 1. MEASUREMENTS WERE OBTAINED VIA THE NORTH CAROLINA REAL ESTATE COMMISSION GUIDELINES.  
 2. DIMENSIONS ARE ROUNDED TO THE NEAREST 1/2 FOOT AND ARE APPROXIMATE.  
 3. INFORMATION WITHIN THESE DRAWINGS ARE INTENDED SOLELY FOR THE USE OF REALTY MARKETING. NOT FOR CONSTRUCTION.  
 4. FOR MORE INFORMATION REGARDING MEASUREMENTS, MARKETING FLOOR PLANS, OR REMODEL DESIGN & CONSULTING, CONTACT **WES HOGAN** AT:  
**FeaturedListingsWNC@gmail.com** OR **828.577.191**