

Plot File 13 Slide 142

NCGS (NAD 83/1986) TIES FROM NCGS MONUMENT "HALLELUJAH" TO EACH OF THE INDIVIDUAL UNITS with FINISH FLOOR ELEV and CEILING ELEV

Course	Bearing	Distance	Unit #	Finish Floor Elev	Ceiling Elev
A	N29°48'12"E	1008.91'	UNIT 301	2190.73'	2202.25'
B	N33°40'19"E	992.39'	UNIT 302	2190.73'	2202.25'
C	N30°05'27"E	1054.88'	UNIT 303	2190.73'	2202.25'
D	N33°39'47"E	1052.46'	UNIT 304	2190.73'	2202.25'
E	N30°20'20"E	1098.04'	UNIT 305	2190.73'	2202.25'
F	N33°53'57"E	1083.38'	UNIT 306	2190.73'	2202.25'
G	N33°59'42"E	1126.92'	UNIT 308	2190.73'	2202.25'
H	N34°04'52"E	1194.15'	UNIT 310	2190.73'	2202.25'
I	N29°47'17"E	1217.17'	UNIT 312	2190.73'	2202.25'
J	N30°34'24"E	1144.67'	UNIT 313	2190.73'	2202.25'
K	N27°46'24"E	1224.93'	UNIT 314	2190.73'	2202.25'
L	N28°24'44"E	1149.90'	UNIT 315	2190.73'	2202.25'
M	N26°17'49"E	1230.30'	UNIT 316	2190.73'	2202.25'
N	N23°28'55"E	1168.27'	UNIT 317	2190.73'	2202.25'
O	N23°40'18"E	1203.61'	UNIT 318	2190.73'	2202.25'

(SEE NOTE #15 REGARDING CEILING ELEVATIONS)

ARCHITECT STATEMENT

- 1) THESE DRAWINGS ARE BASED IN PART UPON THE REPRESENTATIONS OF OTHERS AND ARE NOT FOR BIDDING, CONSTRUCTION OR PERMITTING PURPOSES.
- 2) BASE BUILDING PLANS ARE COPIED FROM CONSTRUCTION DOCUMENTS PREPARED AS PART OF BASE BUILDING CONSTRUCTION BY CALLOWAY JOHNSON, MOORE & WEST, ARCHITECTS OF RECORD.
- 3) I HEREBY CERTIFY THAT THESE PLANS FULLY AND ACCURATELY DEPICT THE LAYOUT, LOCATION, FLOOR ELEVATIONS, UNIT NUMBERS, AND DIMENSIONS OF THE UNITS AS BUILT.

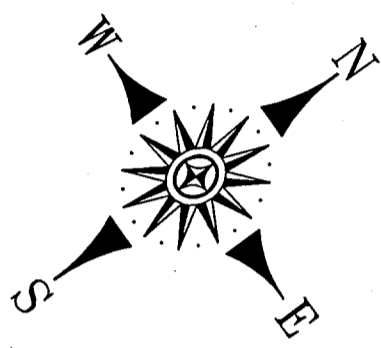

NCGS NORTH NAD 83/1986

DOUGLAS K. HARRIS REGISTERED ARCHITECT 7999

DATE 6.14.09

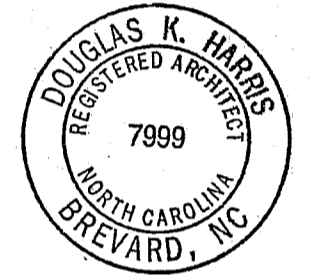

LEGEND:

- 3.02' ELEV: ASTERISK DENOTES ADJUSTED DISTANCE (INCOMPLETE WALL CONSTRUCTION)
- S.F.: SQUARE FEET
- LIMITED COMMON ELEMENT (LCE): [Hatched box symbol]

2009003270

TRANSYLVANIA CO, NC FEE \$21.00
 PRESENTED & RECORDED:
 06-10-2009 04:33:37 PM
 CINDY M OWNBEY
 REGISTER OF DEEDS
 BY: TERESA D MORTON
 DEPUTY REGISTER OF DEEDS
 PF 13
 PG:142-142

WITNESS MY ORIGINAL SIGNATURE, LICENSE NUMBER, AND SEAL THIS THE 15 DAY OF May, 2009

Robert L. Hafler
ROBERT L. HAFLER
PROFESSIONAL LAND SURVEYOR
L-2975

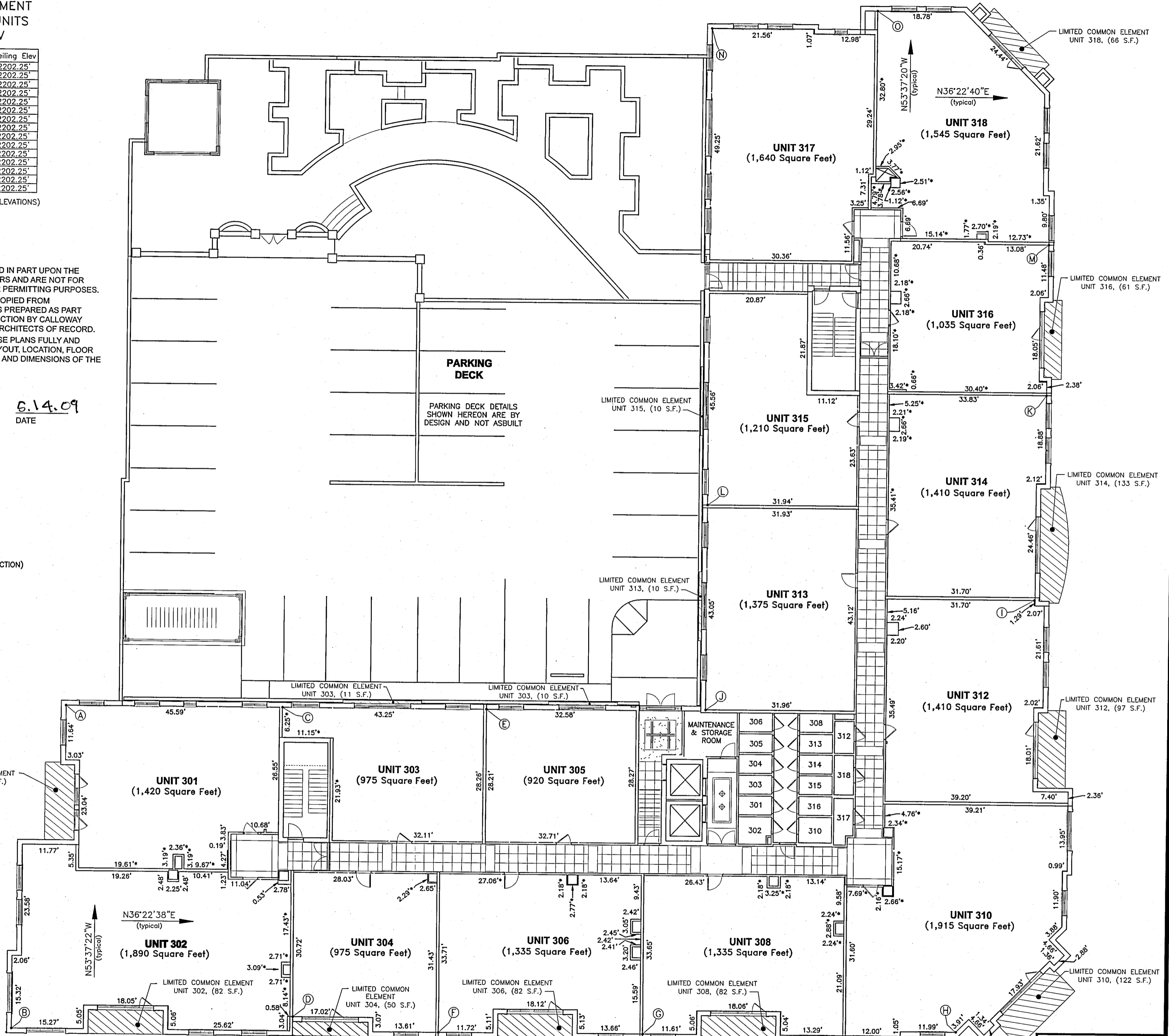
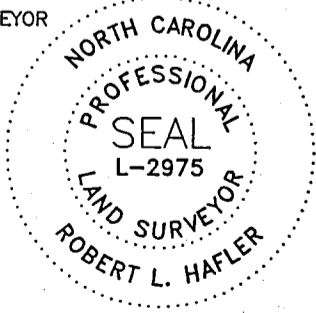

PREPARED BY
HAFLER LAND SURVEYING
 435 S. CALDWELL STREET
 BREVARD, NORTH CAROLINA 28712
 (828) 884-7168
 FAX (828) 884-8646



Property Situate in
 CITY OF BREVARD
 BREVARD TOWNSHIP
 TRANSYLVANIA COUNTY
 NORTH CAROLINA

FINAL PLAT
 of the
FRENCH BROAD PLACE
 CONDOMINIUMS (3rd Floor)

DATE
 Revised: April 20, 2009
 MARCH 31, 2009

FIELD RECORDS
 DATA COLLECTOR

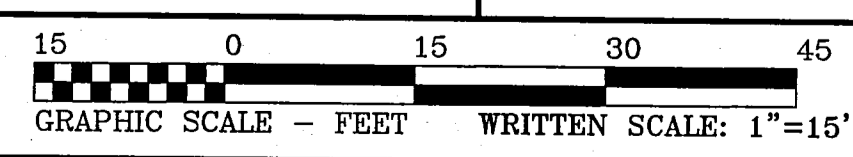

SHEET 4 of 6
 DRAWING
 3rd FLOOR HLS CondoDocs
 COORDINATE FILE
 PN07003.crd
 PROJECT NUMBER
 PN09004