

PENNSYLVANIA COUNTY HEALTH DEPARTMENT

Sewage Disposal System Improvements Permit and Certificate of Completion Sewage Treatment and Disposal Rules (Article 11 of Chapter 130A of the General Statutes of North Carolina)

* Keep tanks ^{5'} min. from basement wall.
 * Due to steep slope, drainfield may require manual installation.
 Date: August 6, 1991 8583-74-6811-000 Permit Valid 5 YRS. FROM DATE OF ISSUANCE
 Owner/Agent: Charles H. Peters Receipt No.: ck dtd 4/3/90 by Peters
 Address: 38 Henry Mtn. Brevard Phone No.: 966-4583
 Location of Property: At intersec. of Greenville Hwy. and Cantrell Mtn. Road.

Subdivision: _____ Lot Number: _____ Section: _____ Plat of Property: Yes No
 Type of Facility: House Mobile Home Business Basement Yes No Basement Plumbing Yes No
 Number of Bedrooms: 3 Number of Bathrooms: 3.5 Estimated Sewage Flow: 360 gpd
 Lot Size: 6 acres Easements, Right-of-Ways, etc.: power Date Lot Recorded: post '83
 Type of Water Supply: Individual-Drilled Well Spring Public/Community

Signature/Authorized Agent: Charles H. Peters Date: Aug 6 91

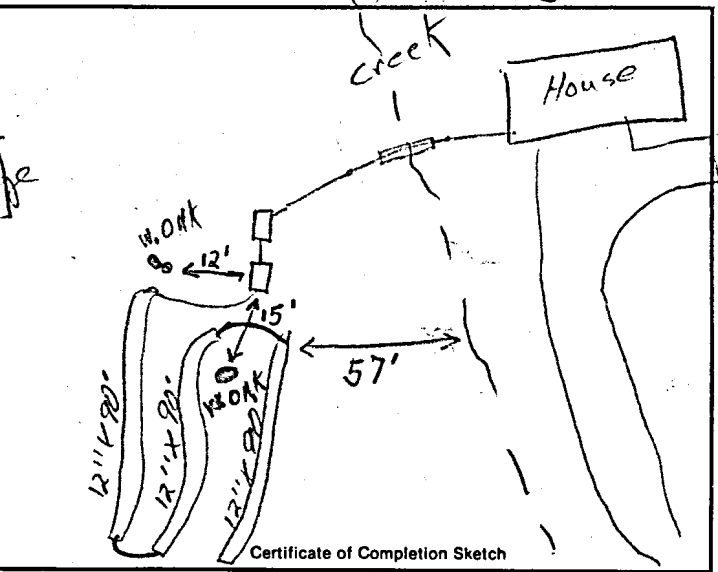
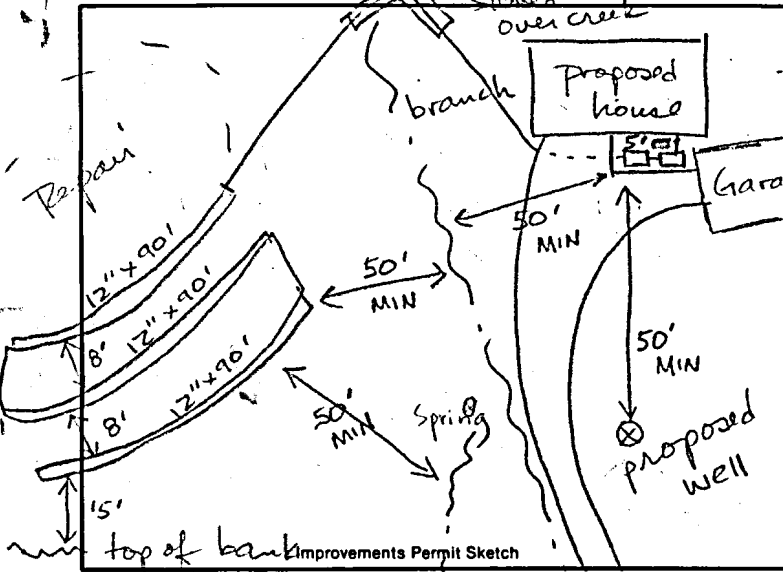

Nitrification trenches shall be installed on level grade with contour. Stepdowns permitted only when indicated.

New System Repair Addition
 Size of Tank: 1000 Application Rate: 6 gpd/ft²
 No. of Lines: 3 Width: 12-14" Linear Ft.: 90'
 Square Ft.: 650 Maximum Trench Depth: 18" low side

I understand and agree to install the septic tank system as specified on this Improvements Permit. Permit is void if any changes are made without consent of the Health Department Representative and/or if any false information is supplied in making Improvements Permit.

Signature/Authorized Agent: Charles H. Peters Date: 8/16/91
 By: Thomas R. Ralsh RS Date: 8/16/91

Building Contractor: B.I.G. Inc.
 System Installed by: Ron Moore

This is to certify that system is installed according to Rules and Regulations but is not a guarantee that it will function satisfactorily for any given period of time.

By: Thomas R. Ralsh RS Date: 7/21/92

EXISTING SYSTEM: Addition/Remodeling Relocation

System functioning properly at time of inspection and is approved for proposed additions/renovations.
 By: _____ Date: _____

* Drainfield shall be the "Large Diameter Pipe" System (12" O.D.) and shall be installed level on contour.
 * Pump plans shall be submitted and approved prior to start of septic installation.
 Color Codes: Owner—White; Health Dept.—Green; Improvements Permit—Pink