

1049 KANASGOWA DR., BREVARD, NC 28712

**HEATED LIVING AREA**

MAIN LEVEL = 1352 SF  
 SECOND LEVEL = 769 SF  
 LOWER LEVEL = 1037 SF  
**TOTAL = 3158 SF**

**MAIN LEVEL**  
1352 SF

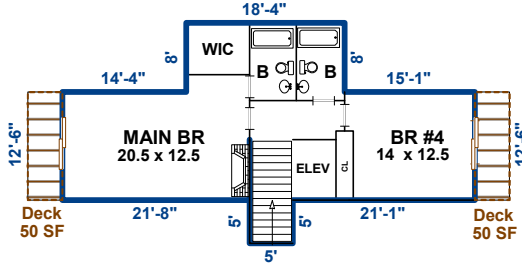
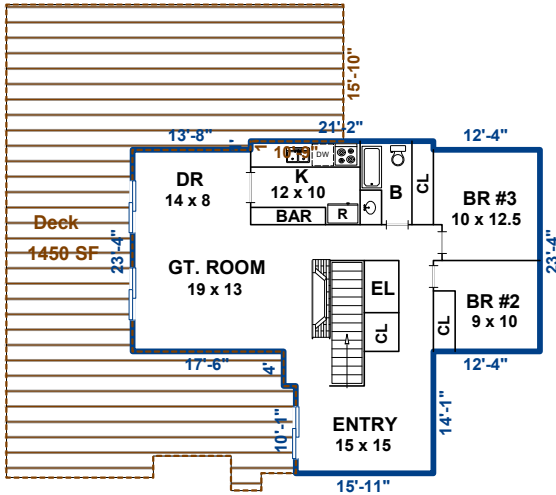

**SECOND LEVEL**  
769 SF

**NOTE:**

The sloped ceiling was measured according to the guidelines that state: "No portion of the HLA that has a ceiling height of less than 5' may be included in the total heated living area."

**LOWER LEVEL**  
1037 SF

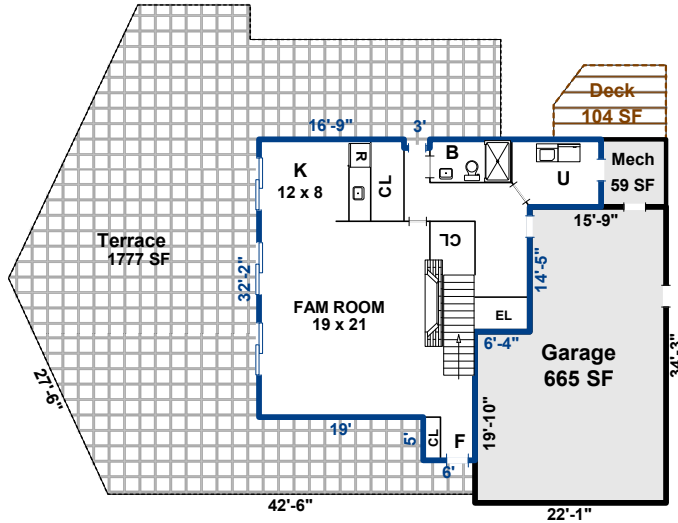

Shaded areas are unfinished.  
 Interior sketches are for illustration purposes only.  
 Prepared by Diane L. Jetton, HMS (828)553-0171; dlj@pobox.com