

**FINISHED HEATED LIVING AREA**

FIRST LEVEL = 650 SF  
 SECOND LEVEL = 655 SF  
 THIRD LEVEL = 764 SF  
 = 2069 SF

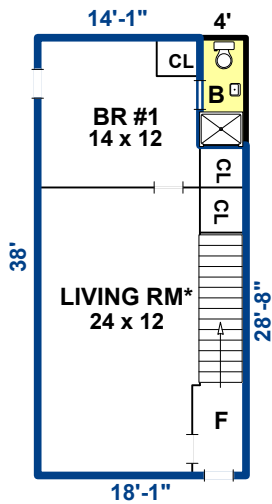

FIRST LEVEL  
650 SF

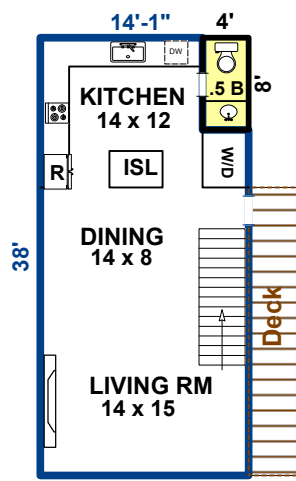

SECOND LEVEL  
655 SF

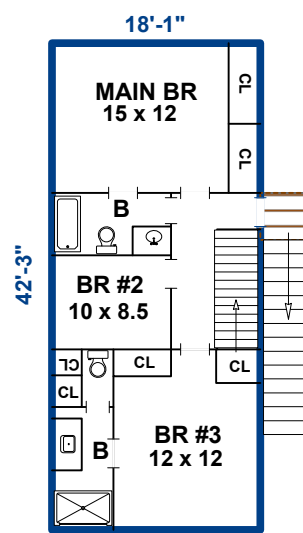

THIRD LEVEL  
764 SF

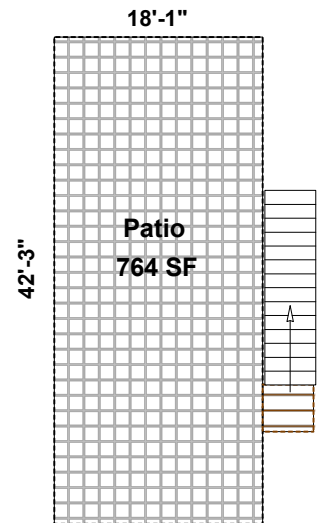

FOURTH LEVEL

 = 1st Level bath (32 sf) and 2nd Level half-bath (37 sf) are finished but have no heat. They are not included in the Heated Living Area total.

\*Note: First level living room has a hinged, fully insulated door. This room is finished, heated, and plumbed for a kitchen. It's intended use is as a living room. It is typical of the area.

Interior sketches are for illustration purposes only.  
 Prepared by Diane L. Jetton, HMS (828)553-0171; dlj@pobox.com