

SKETCH/AREA TABLE ADDENDUM

SUBJECT INFO

File No.: 01102020 Parcel No.: 8586-42-0844-000
 Property Address: 41 Short Street, Brevard, NC 28712
 City: Brevard County: Transylvania State: NC ZipCode: 28712
 Owner: Lytle, Randy
 Client: Paul Wilander, Looking Glass Realty Client Address: 66 S. Broad St., Brevard, NC 28712
 Appraiser Name: RE Broker: Diane L. Jetton, HMS (828)553-0171 Inspection Date: 01/10/2020

SKETCH

APPROXIMATE HEATED LIVING AREA

First Floor	=	852 SF
Second Floor	=	430 SF
Below Grade	=	776 SF
TOTAL	=	2058 SF

OTHER AREAS

Garage	=	400 SF
Mech Rm	=	60 SF

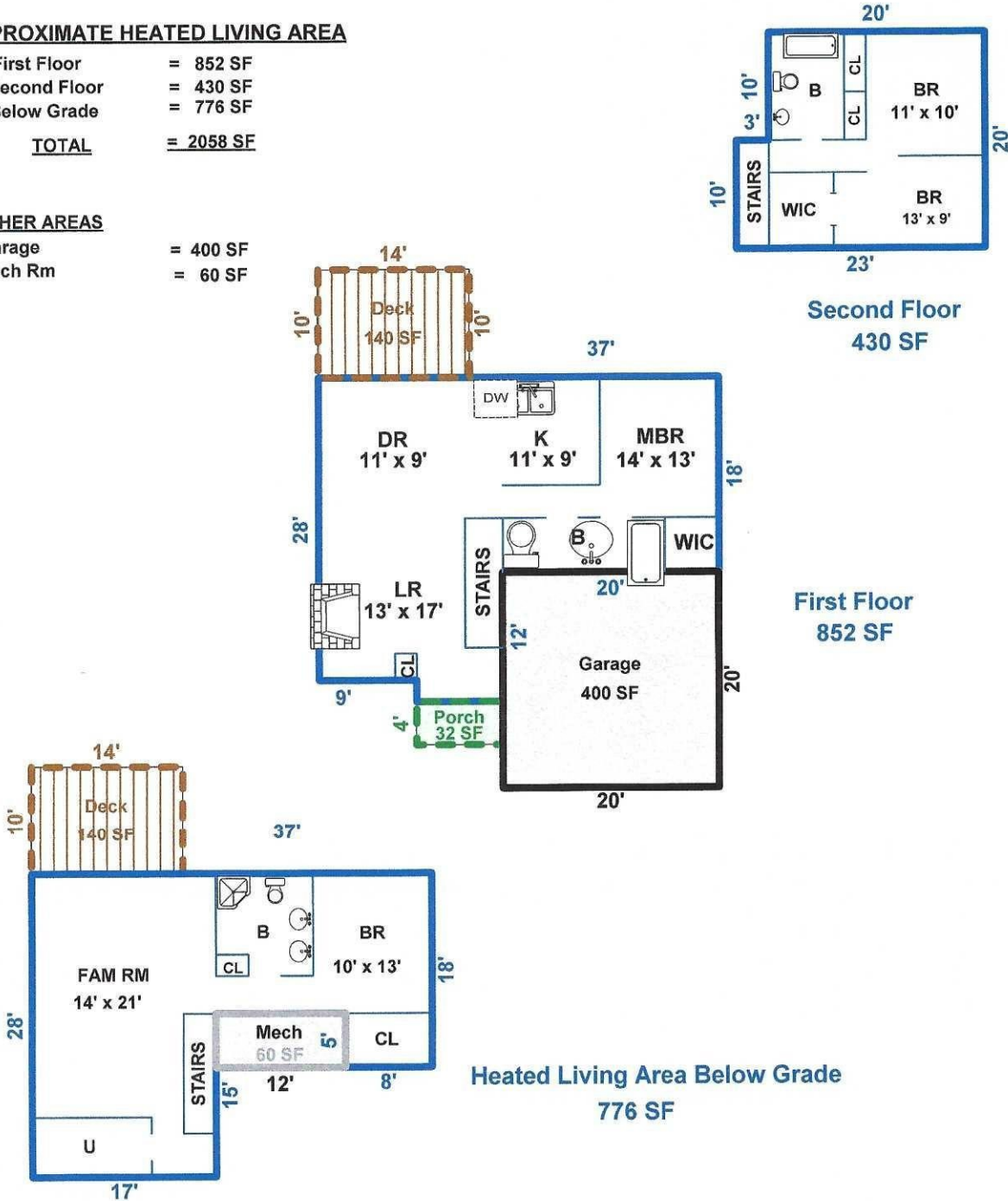

NCREC SF Guidelines permit reporting SF as the total living area without splitting above and below grade SF. Therefore, total living area may be reflected differently by appraisers, lenders, and the NC Building Code. SF calculations follow ANSI Standards and NCREC Guidelines (which are used in this report) and are rounded to the nearest foot. Interior sketches are for illustration purposes only.