

OROURKE BRIAN J ET UX                      N2 FOUND    YR 2023 **S12-K3**                      POLK COUNTY                      **ACCOUNT#:** 55006                      PAGE 1  
 91 GREENVILLE ST                      S12B                      **NBHD:** 0S61    SALUDA RES AREA 61  
 PLAT: C-188                      PIN:                      Plat Bk/Pg F    584    APPR: RV5 APPR DT: 5/29/2019  
       .460 AC TWSP: 002                      **DISTRICT:** 2 SALUDA INSIDE C                      EXCD:                      NOTICE:

Bldg No. 1                      Exempt Code                      **LAND VALUE** 46,000  
 Imp Desc: R12 RES - BED/BREAKFAST                      EYB: 1985                      SMITH DR                      **MISC VALUE** 0  
 Grade : CC+ CI C GRADE PLUS                      AYB: 1925                      Finished Area:                      2,800.00                      **BLDG VALUE** 232,506  
 # of Units                      11 Rms                      6 Bedrms                      5.0 Bathrms                      HBaths                      **TOTAL VALUE** 278,506

TYPE/CODE/DESCRIPTION	PCT	%CMP	UNITS	RATE	STR#	STR%	SIZ%	HGT%	PER%	COST
AC 11 BASEMENT - UNFINISHE	100		1080	26.00						28,080
AC 50 PORCH	100		620	30.00						18,600
AC 50 PORCH	100		96	30.00						2,880
AC 51 PORCH - ENCLOSED	100		160	48.00						7,680
AC 70 LIVING AR-UPPER FIN	100		1080	90.00			70.00			68,040
MA R12 RES-BED/BREAKFAST	100		1720	100.00	1.00		97.00			166,840
- AR 03 NO CONVENTIONAL AIR	100		1720	2.20-						3,784-
- AR 04 NO CONVENTIONAL HEAT	100		1720	2.20-						3,784-
- DS EC01 BRICK VENEER	100		1720	.00						0
- DS FN 07REINFORCED CONCRETE	100		1720	.00						0
- DS RM01 ASPHALT SHINGLE	100		1	.00						0
- DS RT04 GABLE	100		1	.00						0
- PL 09 5.0 BATHS	100		1	28125.00						28,125
RCN...		PCT COMPLETE			100	x				312,677
QUAL..	CC+				110.00	x				343,944
DEPR.. GD					32.40	-		111,438		111,438
--ASV...										232,506

PROPERTY NOTES:	PERMIT NO	TYPE	DATE	BOOK	PAGE	DT	DATE	QS	SALES	PRICE
	458			654		WD	4/09/2021		579,000	
	AMOUNT			415	1681	WD	1/01/2016		244,000	
	AMOUNT			329	1	SPL	6/27/2005			

MISC CODE	DESC	UNITS	RATE	AYB	EYB	DT	PCT	%CMP	ADD.DEPR	PCT	VALUE	EXMPT
							.00					
							.00					
							.00					
							.00					

#	ZONE	TYPE/CODE	LAND QTY	LAND RATE	DPTH	DPT%	TOP%	LOC%	SIZ%	SHP%	OTH%	ADJ	FMV	EXMPT
1		AC BS	.460	100,000.00		.00	.00	.00	.00	.00	.00	.00	46,000	

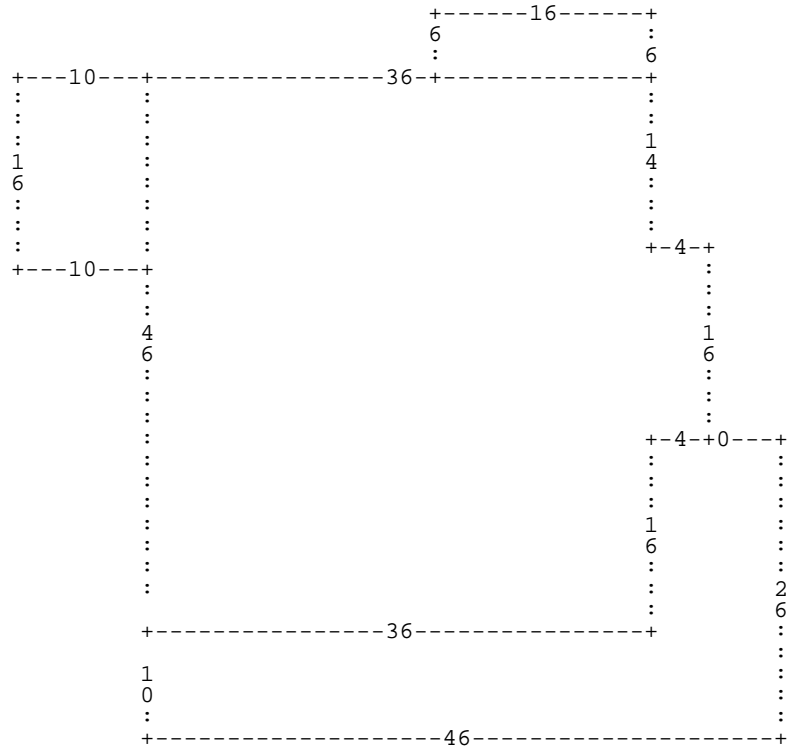

= AC 50  
= MA R12

620.00 PORCH  
1,720.00 RES-BED/BREAK

= AC 50

96.00 PORCH

= AC 51

160.00 PORCH - ENCLO