

Foothills Health District
Environmental Health Records Request Form

RUTHERFORD COUNTY
ENVIRONMENTAL HEALTH
221 Callahan Koon Road
Spindale, NC 28160
Phone: 828-287-6317
Fax: 828-287-6479
rutherfordenv@foothillshd.org

McDOWELL COUNTY
ENVIRONMENTAL HEALTH
408 Spaulding Road
Marion, NC 28752
Phone: 828-652-2921
Fax: 828-652-2019
mcdowellenv@foothillshd.org

General Searches Must Be Requested In Writing At Least Two Weeks Prior To The Requested Search Date.

Property Information:

Date of Request: 3/30/2023

1. Original Owner Name: Edgerton Jr., Hoyle H. & Margaret - Edgerton, David W. & Carolyn

Original Builder Name: unknown

2. List All Other Possible Names The Information Could Be Filed Under:

Robertson, Wilma J

3. Property I.D.# (PIN): 1519722736

4. Property Address: 139 General Griffith Circle, Rutherfordton, NC 28139

5. Year Home Built: 1999

6. Year Septic/Well Installed: 1999

7. Subdivision & Lot #: Rutherford Towne. Lot 41

Information On 1 thru 7 **MUST** Be Completed In Order To Perform A Records Search

Please Be Advised That Septic Records Prior To 1975 Are Often Non-Existent.

PLEASE WRITE LEGIBLE
SEND INFORMATION TO:

Name: Mark Lauer

Email: mark@lookingglassrealty.com

Phone: 828-808-2976

Fax: _____

**All Information MUST Be Completed Or A Record Search Cannot Be Performed.
(Incomplete Requests Will Be Returned)**

RECORDS REQUEST SEARCH: Faxed Record Not Found Request Incomplete Emailed

DATE RETURNED: 4/16/23 *(initials)*

The first copy page of any record request is at no charge. Subsequent copy pages will be charged for according to the current fee schedule.

- New
- Repair
- Addition

APPLICATION # OLO PERMIT

Rutherford-Polk-McDowell District Health Department Operation Permit

(Permit subject to revocation if site plans or intended use change)

Owner or Legal Agent: RUTHERFORD TOWN BLDGS County: RUTHERFORD
 No. of Trenches: 3 Trench Length: 120' Trench Width: 24"
 Type of system: III SBI# GRAVELLESS System installed by: W F Wilson
 Conditions/Comments: _____

Owner or Legal Agent: RUTHERFORD TOWN BUILDERS - LOT #41

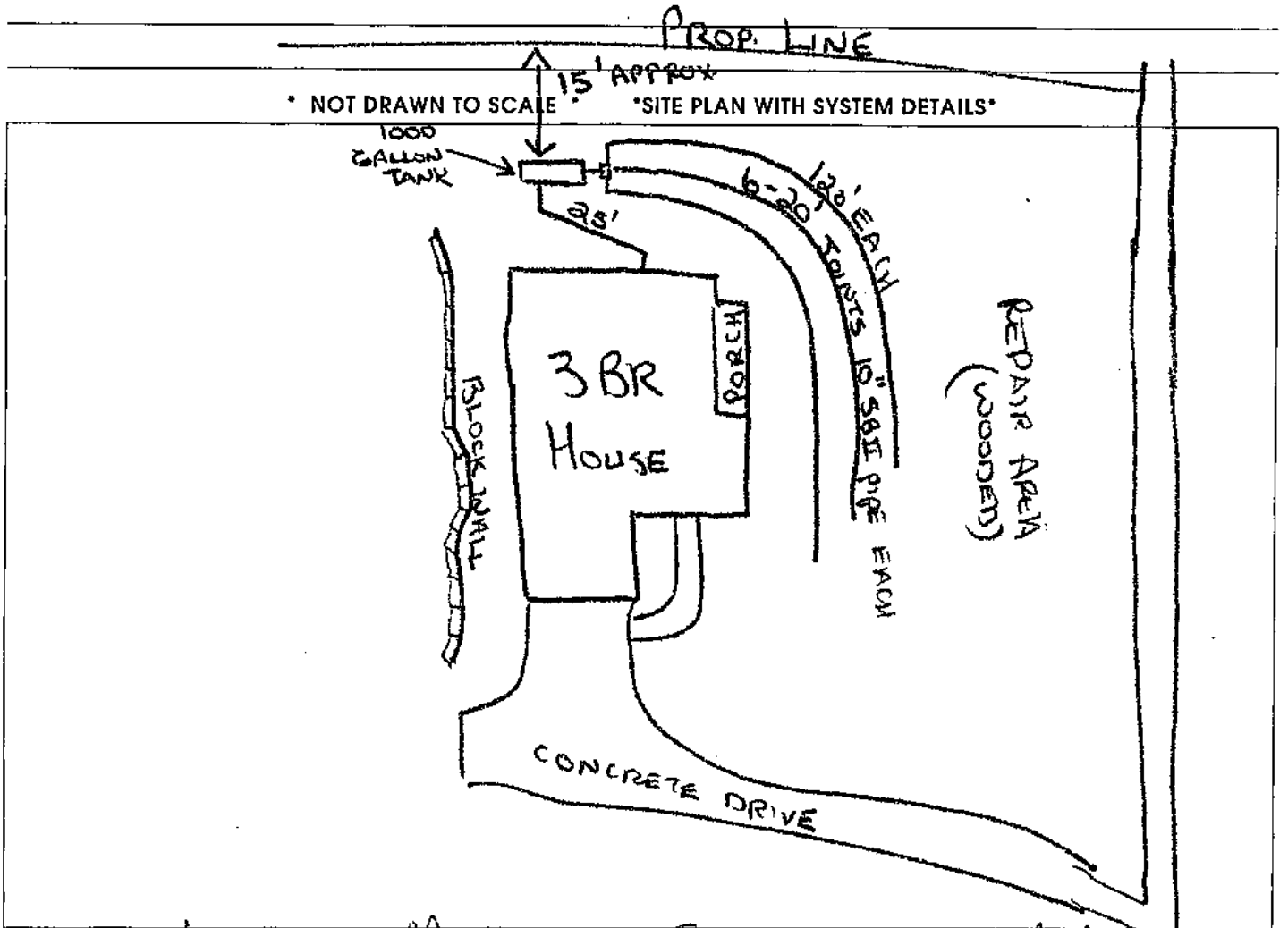

Issued By: Dr. E. Mathews, RS Date: 10/14/99
 Environmental Health Specialist

COMPLETION OF THIS OPERATION PERMIT ALLOWS THE SYSTEM TO BE PLACED INTO USE. PROPER CARE OF YOUR SEPTIC SYSTEM REQUIRES MANAGEMENT AS WELL AS PERIODIC MAINTENANCE.

OPERATION AND MAINTENANCE RECOMMENDATIONS

- (1) The drainfield does not have unlimited capacity. Try to limit the volume of your wastewater and repair any dripping faucets or toilets. Be sure that the water from the roof gutters, foundation drains, and ground surface does not flow over the system.
- (2) Do not add materials such as hygiene products, cigarette butts, coffee grinds, disposable diapers, cooking oils or grease to the septic tank system and restrict the use of garbage disposals.
- (3) Maintain a grass vegetative cover over the drainfield to prevent soil erosion.
- (4) Avoid driveway construction or other over the system and repair area and keep autos and heavy equipment off the system. Do not cover with fill dirt.
- (5) Don't wait until your drainfield fails to have your tank pumped, by then the drainfield may be ruined. Have solids pumped out of the tank as needed, usually every 3-5 years.