

COUNTY PIN#: 1638002

APPLICATION#: SW21-0368

- New
- Repair
- Re Evaluation
- Addition/Expansion
- Non Residential

**FOOTHILLS HEALTH DISTRICT
AUTHORIZATION TO CONSTRUCT**

Valid for 5 Years from Date of Issue.

(Permit subject to revocation if site plans or intended use changes)

- Septic and Well
- Septic only
- Well Only
- Tank Only

Applicant/Legal Agent: Ridgeline Log Homes/ Tanner, Alan County: R M O
 Property Location: Chasewood Drive Subdivision: Deer Run Lot#: 15 Code: 0

Facility Type: House System Type: 25% Reduction Basement: Y N With Plumbing: Y N
 No. Bedrooms: 3 Occupancy / Users: 6 Design Flow Basis: 20 gal / bedroom
 Design Flow: 300 gpd L.T.A.R.: 0.45 gpd/ft² Septic Tank: 1000 gal Pump Tank: gal
 Number of Trenches: Trench Length: 70 70 60 ft. Trench Width: in. Maximum Trench Depth: in.
 Water Supply: Private Well Public/Comm. Spring Other: Well Variance: Y N
 U.S.T.: Y N Lot Size: 1.11 acres Repair System Type: 25% Reduction L.T.A.R.: 0.45 gpd/ft²
 Design Flow Basis: 20 gal / bedroom Comments/Conditions:

- Not to scale
 - Install on contour
 to maintain
 36" trench
 depth

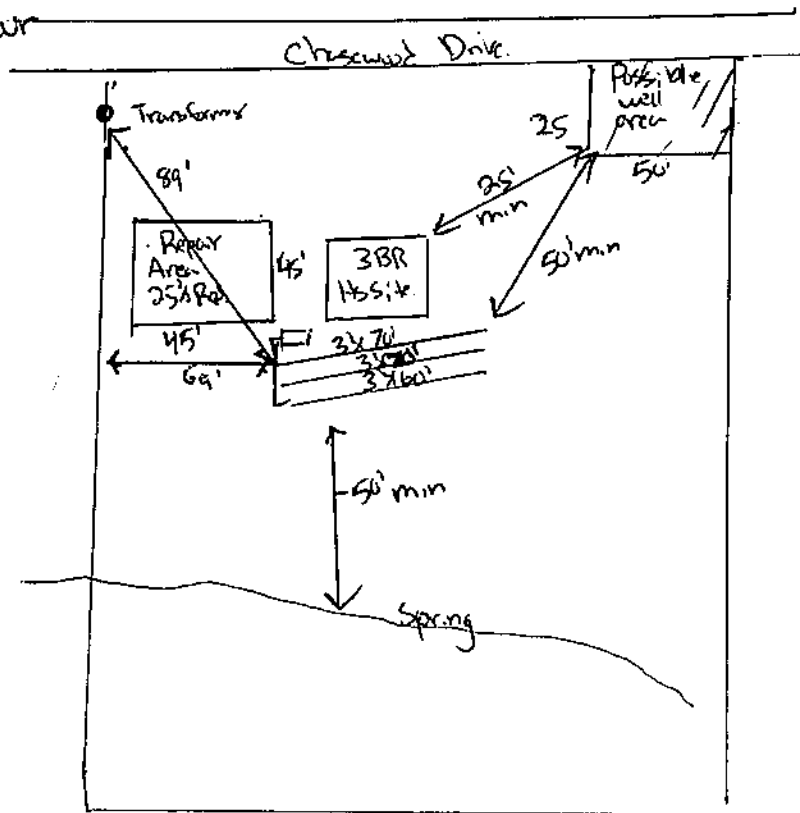

Permit Issued by: [Signature]

IP Date of Issuance: _____

Date: 7-9-21
(VOID AFTER 5 YEARS)

- Septic and Well Septic only Well Only Tank Only

Construction of the wastewater system for the improvement permit indicated above is hereby authorized. The wastewater system described in the improvement permit has been designed and can be installed and operated in compliance with Article 11 Chapter 130A of the General Statutes of N.C. and rules adopted pursuant to this article. Any alteration of the site or soil conditions, changes to the proposed facility to be served, or submission of false information may subject the permit and authorization to suspension or revocation.

Rutherford County Environmental Health: (828) 287-6317 McDowell County Environmental Health (828) 652-2921