

First Floor
[547.49 Sq ft]

TOTAL Sketch by a la mode

Area Calculations Summary

| Living Area | | Calculation Details | |
|------------------------------|--------------|---------------------------------------------------------|-----|
| First Floor | 547.49 Sq ft | $12.3 \times 12.3 = 151.29$ $14 \times 28.3 = 396.2$ | |
| Total Living Area (Rounded): | | 547 Sq ft | |
| Non-living Area | | | |
| 1 Car | 246 Sq ft | $20 \times 12.3 =$ | 246 |
| Attached | 56 Sq ft | $14 \times 4 =$ | 56 |
| Patio | | | |



LOOKING GLASS REALTY

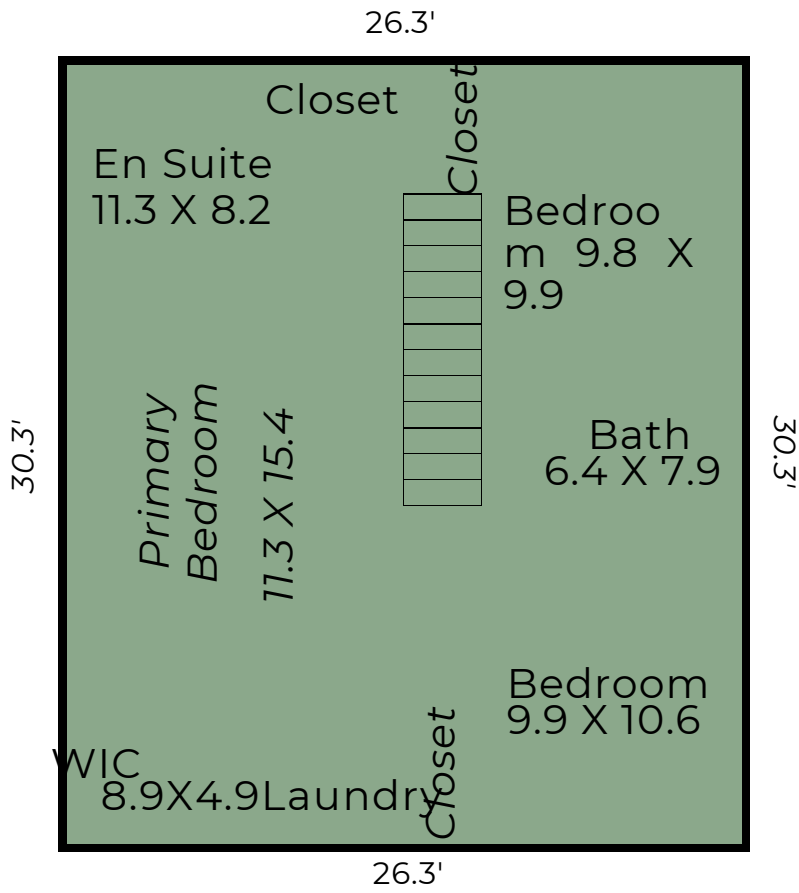

Second Floor
[796.89 Sq ft]

TOTAL Sketch by a la mode

Area Calculations Summary

| Living Area | | Calculation Details |
|------------------------------|--------------|-----------------------------|
| Second Floor | 796.89 Sq ft | $30.3 \times 26.3 = 796.89$ |
| Total Living Area (Rounded): | 797 Sq ft | |



LOOKING GLASS REALTY