

17,362

File 17 Slide 362

Id	Delta	Radius	Arc Length	Chord	Ch Bear
C1	09°39'58"	497.92'	84.00'	83.90'	N 69°09'43" E
C2	09°12'20"	497.92'	80.00'	79.91'	N 59°43'34" E
C3	07°10'59"	497.92'	62.42'	62.38'	N 51°31'54" E

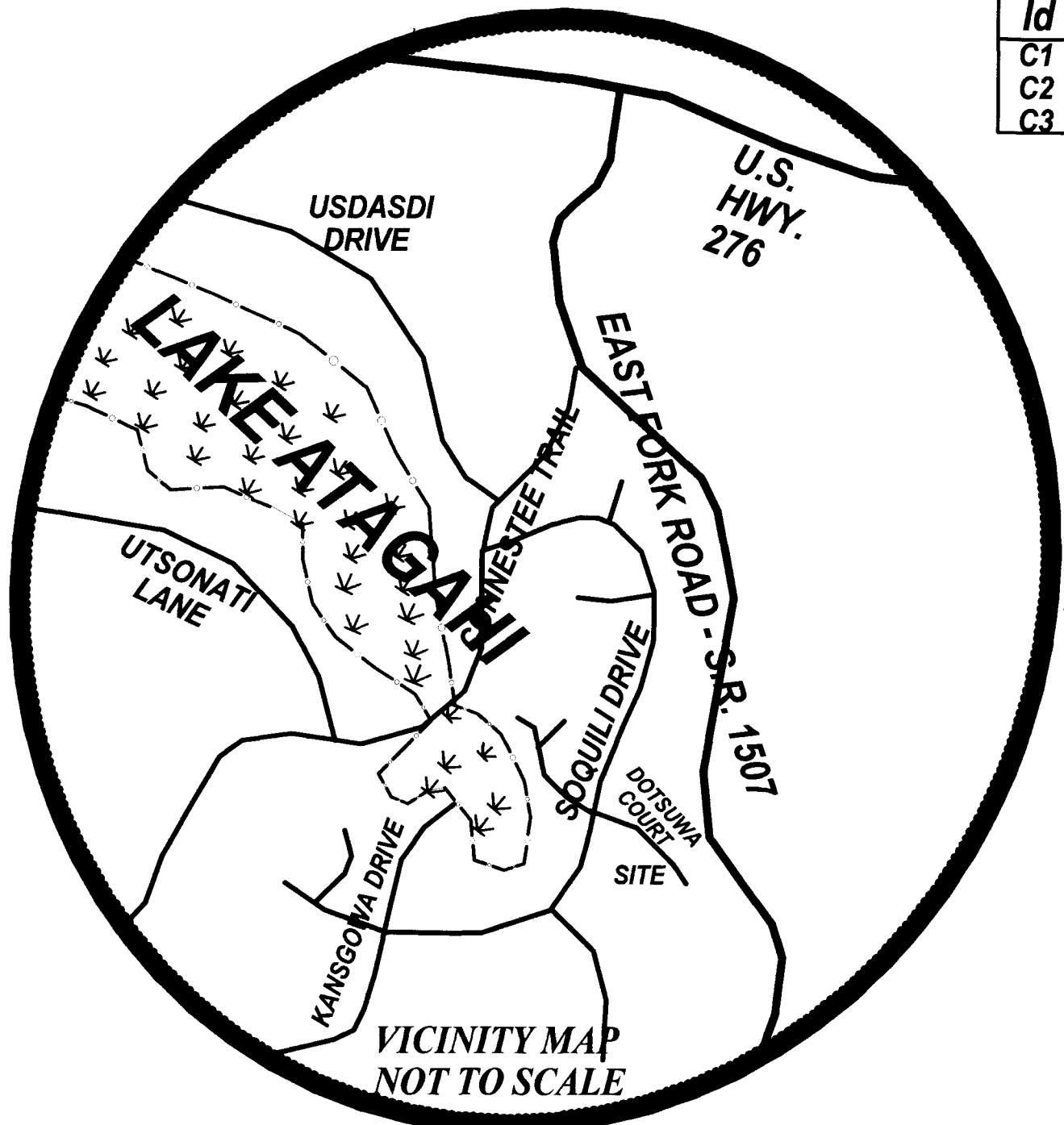

DOTSUWA COURT - PRIVATE ROAD

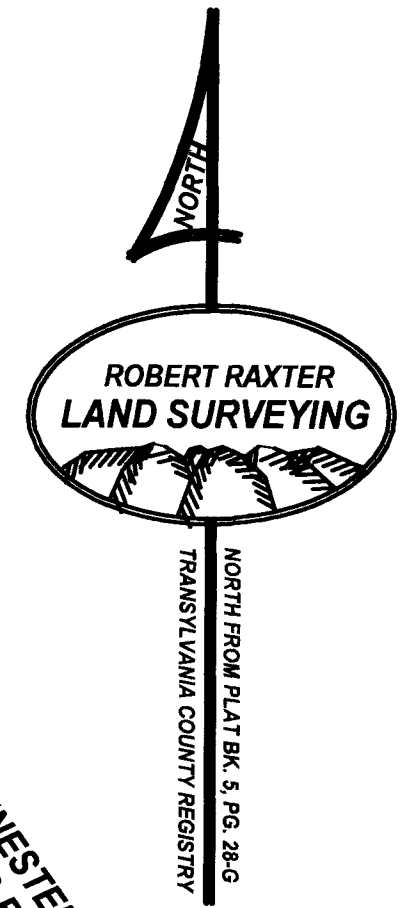

Being all of Lot 132, 133 and 134, - Unit 26 of CONNESTEE FALLS DEVELOPMENT recombined into one lot designated as:

LOT 132-A - UNIT 26 REVISED

1.32 ACRES

I, ROBERT RAXTER, certify that this plat was drawn under my supervision from an actual survey made under my supervision (deed description recorded in Book 342, 401, 320, page 664, 266, 142); that the boundaries not surveyed are drawn from information found in Book 324, 401, 320, page 664, 266, 142, and/or Plat book 5, slide 28-G; that the ratio of precision as calculated is 1' in N/A; that this plat was prepared in accordance with G.S. 47-30 as amended. Witness my original signature, registration number and seal this the 22nd day of NOVEMBER A.D., 2017

L-2785

Surveyor

Registration number

State of North Carolina ----- Transylvania County
 Filed for registration on the _____ day of _____, 20, at _____ o'clock _____ M. and registered and verified on the _____ day of _____, 20 in _____ Plat file _____ Slide no. _____
Register of Deeds, Transylvania County

LEGEND and NOTES:

- EIP = EXISTING IRON PIPE
- EIR = EXISTING IRON ROD
- CMS = CONCRETE MONUMENT SET (CONTROL CORNER)
- ECM = EXISTING CONCRETE MONUMENT
- UP = UNMARKED POINT
- IRS = IRON ROD SET
- ACREAGE CALCULATED BY COORDINATE COMPUTATION
- R/W = RIGHT-OF-WAY
- PI = POINT OF INTERSECTION
- THIS PROPERTY IS SUBJECT TO ALL RESTRICTIONS, SETBACK LINES, ROADWAYS, ZONING ORDINANCES, EASEMENTS AND RIGHTS-OF-WAY APPEARING ON THE PROPERTY AND/OR OF RECORD.
- THIS PLAT WAS PREPARED FROM DEEDS ONLY - NO NEW FIELD SURVEYING PERFORMED AT THIS TIME
- I, ROBERT RAXTER CERTIFY THAT THIS SURVEY IS OF AN EXISTING PARCEL OR PARCELS OF LAND AND DOES NOT CREATE A NEW STREET OR CHANGE AN EXISTING STREET.

THIS SURVEY PLAT OR MAP IS EXEMPT FROM REVIEW BY THE TRANSYLVANIA COUNTY REVIEW OFFICER BECAUSE IT IS WITHIN THE MEANING OF G.S. 47-30(11) C

LOT 135 - UNIT 26 - CONNESTEE FALLS ASSOCIATION - D.P. PLAT BOOK 5, PAGE 28-G

LOT 131 - UNIT 26 - CONNESTEE FALLS PROPERTY OWNERS ASSOCIATION - D.B. 545, PAGE 784

AREA K-26 - CONNESTEE FALLS PROPERTY OWNERS ASSOCIATION PROPERTY

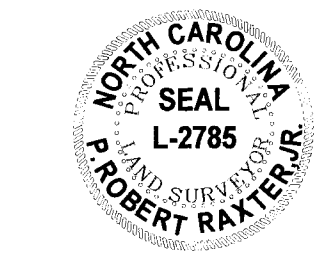

Prepared by:
ROBERT RAXTER
 N.C. PLS L-2785
 641 DOLLY MASTERS RD.
 BREVARD, N.C. 28712
 (828) 507-5535
 DRAWING NO. **A-7710**
 FILE NO. _____

Recombination plat of existing lot prepared for:
JOSEPH J. TALUTO & wife SUSAN I. TALUTO

Dunn's Rock Township
 Transylvania County, N.C.
 Date: November 22, 2017
 Owner: Connetsee Falls Property Owners Association, Inc
 Deed references:
 Deed book 342, page 664
 Deed book 401, page 266
 Deed book 320, page 142
 Plat reference:
 Plat book 5, page 28-G

2017006314
 TRANSYLVANIA CO. NC FEE \$21 00
 PRESENTED & RECORDED
 12-04-2017 11:27:05 AM
 CINDY M OWNBREY
 REGISTER OF DEEDS
 BY: KARRI SMITH
 DEPUTY REGISTER OF DEEDS
 BK: PF 17
 PG: 362-362

SCALE IN FEET - 1" = 30 FEET

