

Crow's Nest Floor Plans

Square footage measurements are calculated in accordance to ANSI guidelines

File No.: 240435	Parcel No.:
Property Address: 376 Whispering Woods Drive	
City: Saluda	County: Polk
State: NC	ZipCode: 28773
Owner:	
Client: Amy Wood	Client Address: Looking Glass Realty
Appraiser Name:	
Inspection Date:	

All data contained herein is deemed reliable, however not guaranteed.

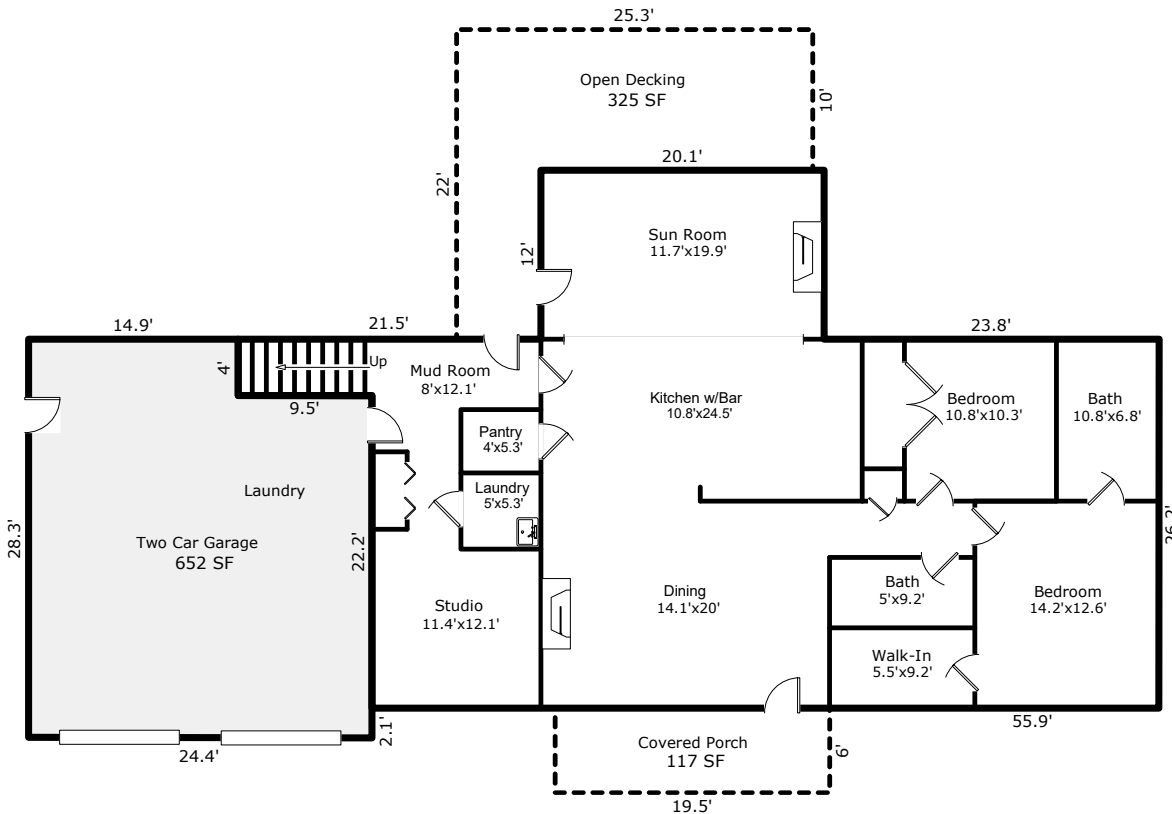

Main Level Finished Living Area = 1,743 SF
 Second Level Finished Living Area = 398 SF
 TOTAL FINISHED LIVING AREA = 2,141 SF

Crow's Nest Floor Plans

Square footage measurements are calculated in accordance to ANSI guidelines

File No.: 240435	Parcel No.:		
Property Address: 376 Whispering Woods Drive			
City: Saluda	County: Polk	State: NC	ZipCode: 28773
Owner:			
Client: Amy Wood		Client Address: Looking Glass Realty	
Appraiser Name:		Inspection Date:	

All data contained herein is deemed reliable, however not guaranteed.

