

Gross Living Area: 3363 sq. ft

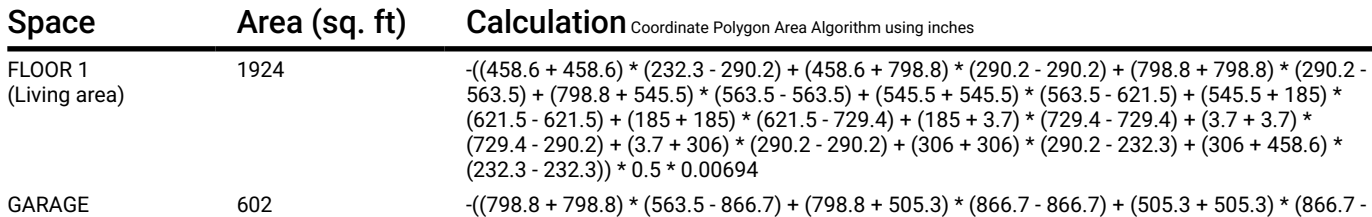

428 Devils Hole RD,Rosman,North Carolina ,United states

Gross Living Area: 3363 sq. ft

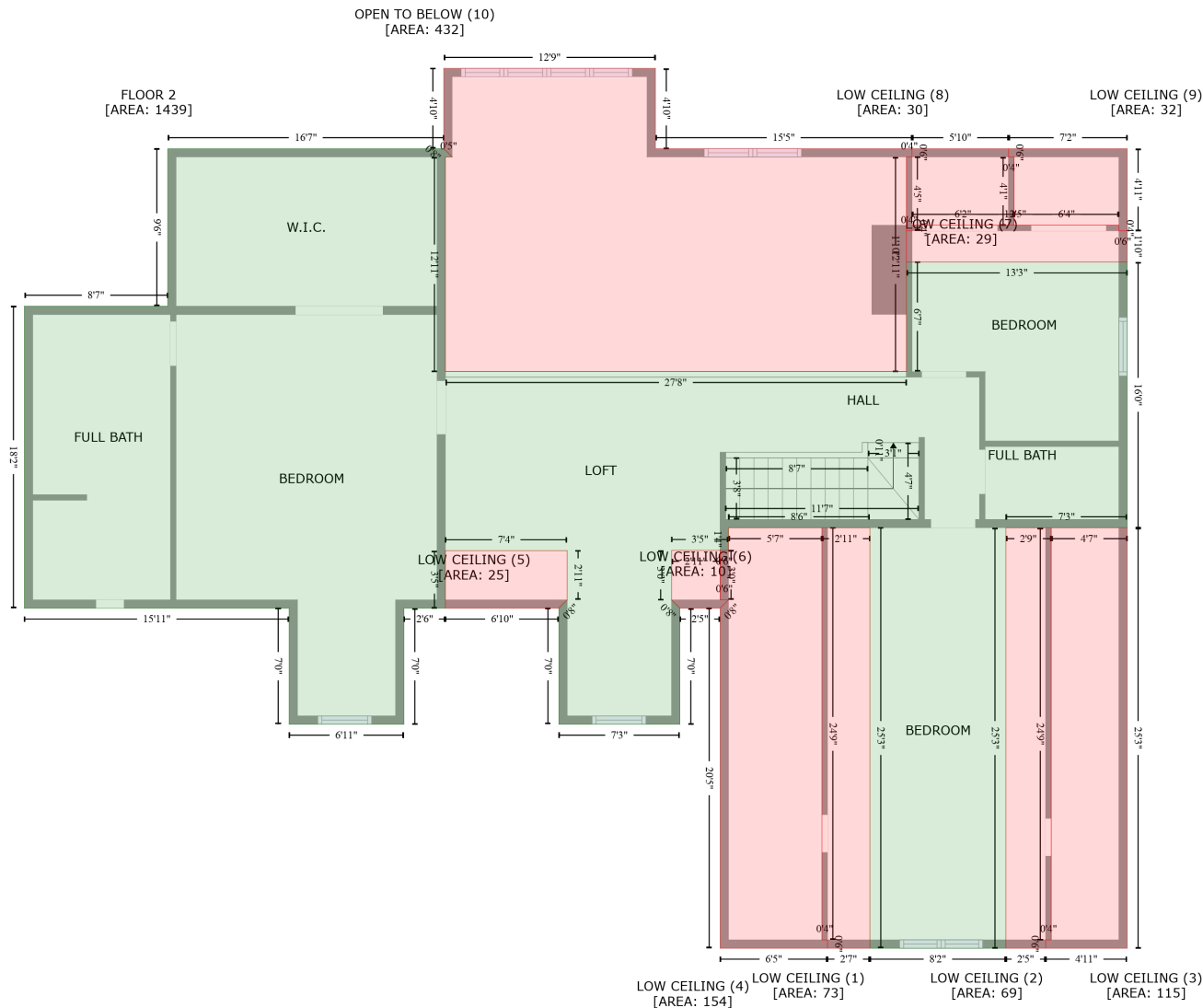

Space	Area (sq. ft)	Calculation
FLOOR 2 (Living area)	1439	Coordinate Polygon Area Algorithm using inches $-((306 + 312) * (290.2 - 296.2) + (312 + 307.2) * (296.2 - 296.2) + (307.2 + 307.2) * (296.2 - 450.9) + (307.2 + 639.6) * (450.9 - 450.9) + (639.6 + 639.6) * (450.9 - 371.9) + (639.6 + 798.8) * (371.9 - 371.9) + (798.8 + 798.8) * (371.9 - 563.5) + (798.8 + 711.3) * (563.5 - 563.5) + (711.3 + 711.3) * (563.5 - 866.7) + (711.3 + 613.2) * (866.7 - 866.7) + (613.2 + 613.2) * (866.7 - 563.5) + (613.2 + 511.3) * (563.5 - 563.5) + (511.3 + 511.3) * (563.5 - 579.9) + (511.3 + 470.3) * (579.9 - 579.9) + (470.3 + 470.3) * (579.9 - 615.5) + (470.3 + 476.3) * (615.5 - 621.5) + (476.3 + 476.3) * (621.5 - 705.2) + (476.3 + 389) * (705.2 - 705.2) + (389 + 389) * (705.2 - 621.5) + (389 + 395) * (621.5 - 615.5) + (395 + 395) * (615.5 - 580.1) + (395 + 307.2) * (580.1 - 580.1) + (307.2 + 307.2) * (580.1 - 621.5) + (307.2 + 277.3) * (621.5 - 621.5) + (277.3 + 277.3) * (621.5 - 705.2) + (277.3 + 194.5) * (705.2 - 705.2) + (194.5 + 194.5) * (705.2 - 621.5) + (194.5 + 3.7) * (621.5 - 621.5) + (3.7 + 3.7) * (621.5 - 403.8) + (3.7 + 107) * (403.8 - 403.8) + (107 + 107) * (403.8 - 290.2) + (107 +$