

Chasewood

Master Plan

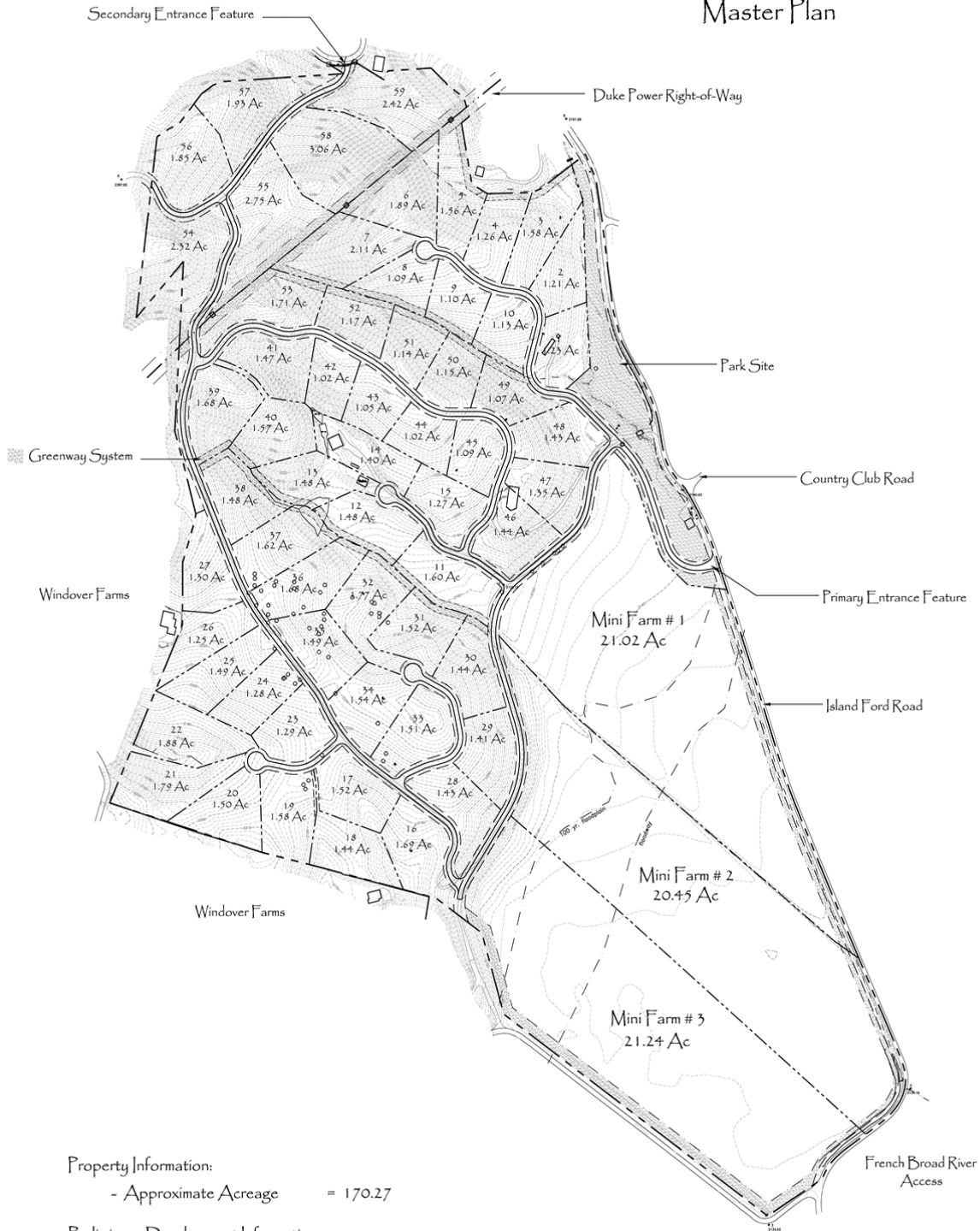

Property Information:

- Approximate Acreage = 170.27

Preliminary Development Information:

- Lots (1-4 Acres) = 59 @ 89.98 Ac

- Mini Farms (15-30 Acres) = 3 @ 62.71 Ac

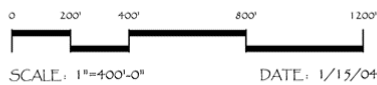
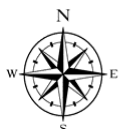

DATE: 1/15/04



Scott R. Melrose & Associates, P.A.
 Landscape Architecture
 Land Planning
 Environmental Design
 3 White Oak Road
 Arden, North Carolina 28704
 Phone (919) 684-5155 Fax (919) 684-5156

This is a graphic representation of a preliminary plan and is subject to change.