

Crow's Nest Floor Plans

Square footage measurements are calculated in accordance to ANSI guidelines

| | |
|--|--------------------------------------|
| File No.: 240710 | Parcel No.: |
| Property Address: 534 Louisiana Avenue | |
| City: Saluda | County: Polk |
| State: NC | ZipCode: 28773 |
| Owner: | |
| Client: Amy Wood | Client Address: Looking Glass Realty |
| Appraiser Name: | Inspection Date: |

All data contained herein is deemed reliable, however not guaranteed.

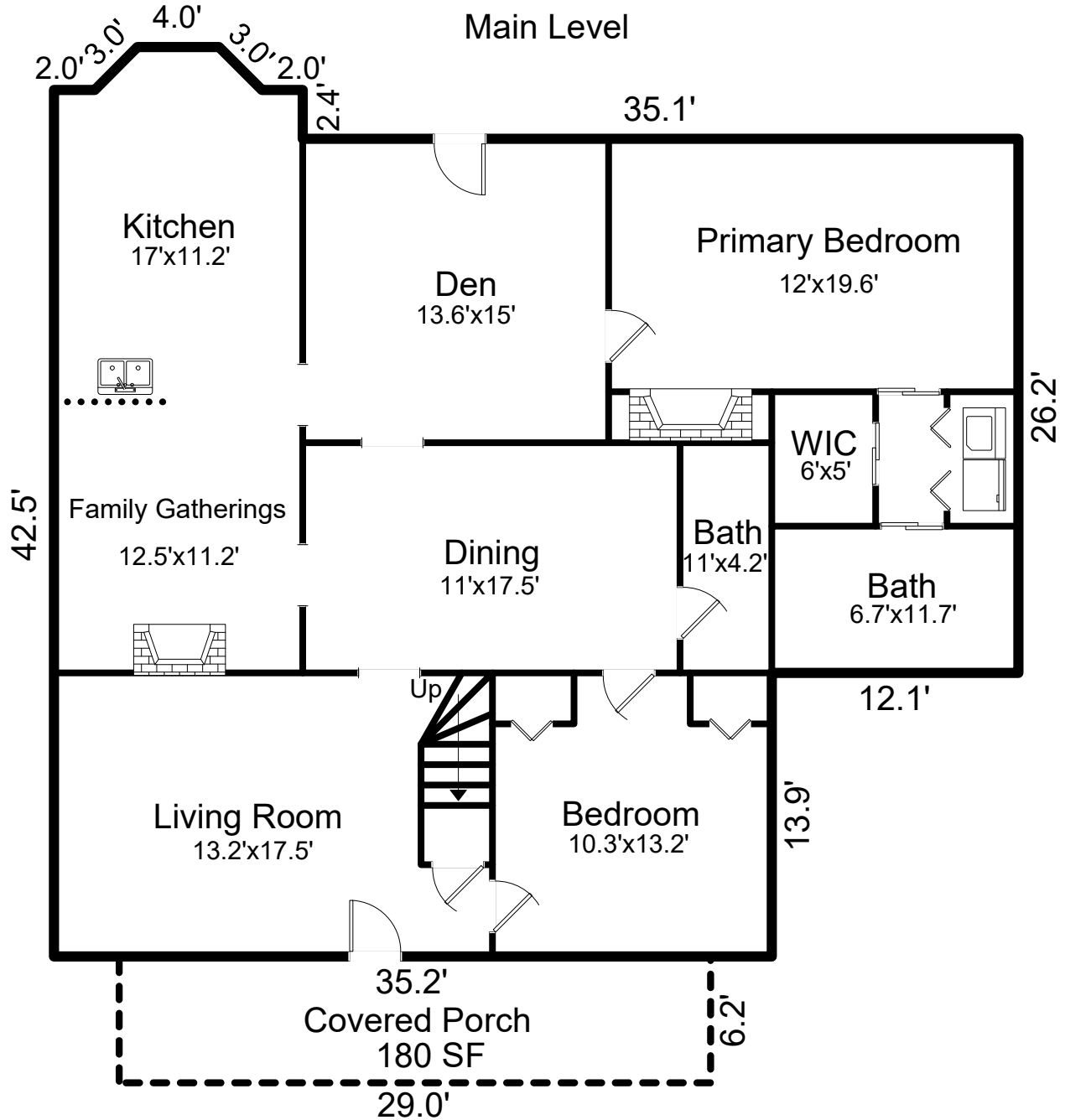

Main Level Finished Living Area = 1,771 SF
 Second Level Finished Living Area = 496 SF
TOTAL FINISHED LIVING AREA = 2,267 SF

Interior Room Dimensions Are Approximate

Crow's Nest Floor Plans

Square footage measurements are calculated in accordance to ANSI guidelines

File No.: 240710

Parcel No.:

Property Address: 534 Louisiana Avenue

City: Saluda

County: Polk

State: NC

ZipCode: 28773

Owner:

Client: Amy Wood

Client Address: Looking Glass Realty

Appraiser Name:

Inspection Date:

All data contained herein is deemed reliable, however not guaranteed.

Second Level

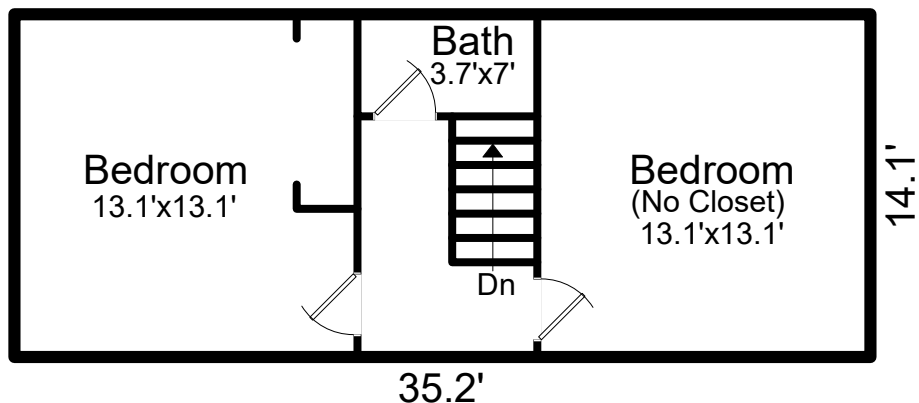

Second Level Finished Living Area = 496 SF

Crow's Nest Floor Plans

Square footage measurements are calculated in accordance to ANSI guidelines

| | | | |
|--|--------------|--------------------------------------|----------------|
| File No.: 240710 | Parcel No.: | | |
| Property Address: 534 Louisiana Avenue | | | |
| City: Saluda | County: Polk | State: NC | ZipCode: 28773 |
| Owner: | | | |
| Client: Amy Wood | | Client Address: Looking Glass Realty | |
| Appraiser Name: | | Inspection Date: | |

All data contained herein is deemed reliable, however not guaranteed.

Detached Two Story Garage

