

# 905 Utsonati Lane, Brevard, North Carolina 28712, United States

Gross Living Area: 2530 sq. ft

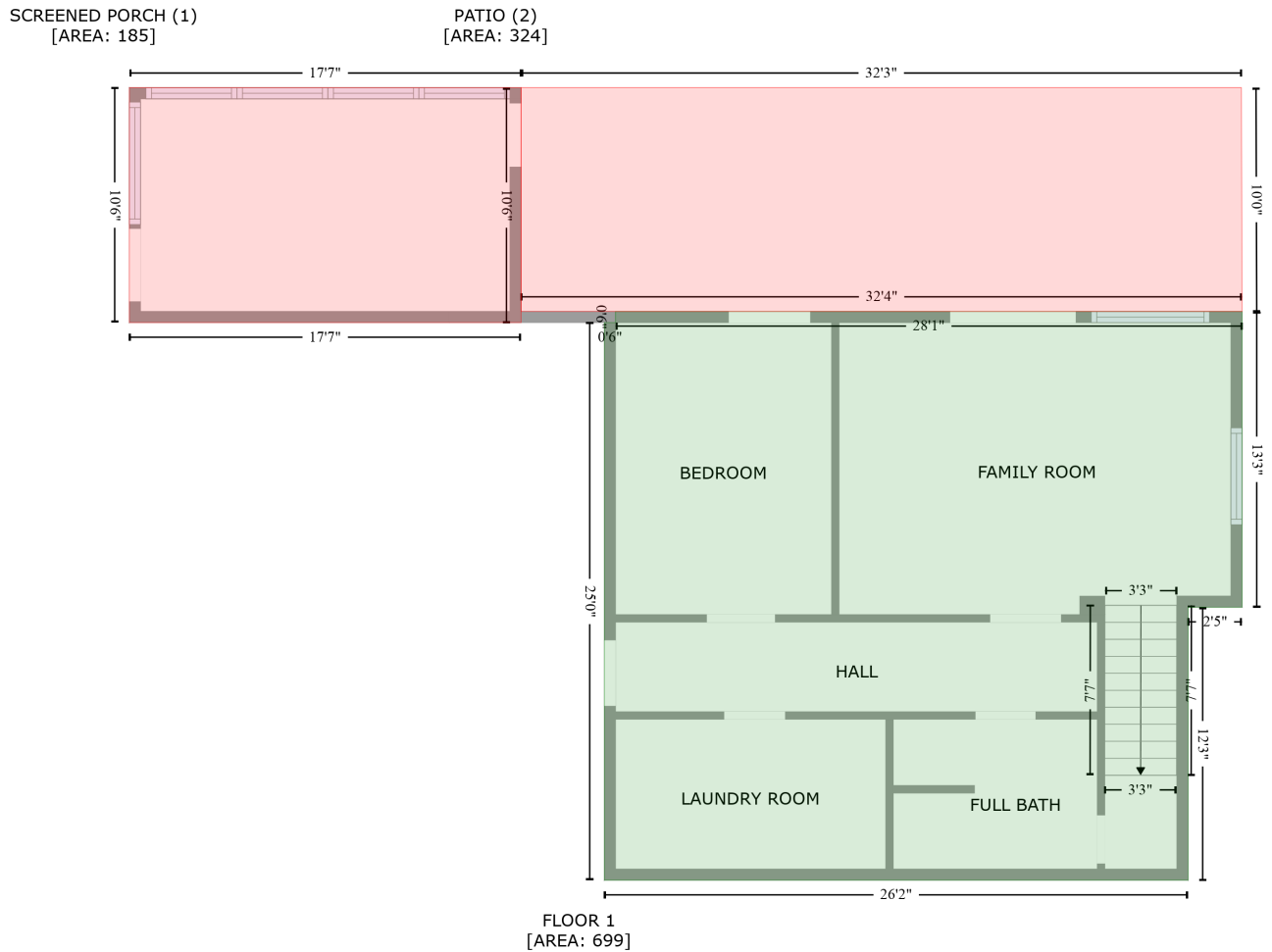

Space	Area (sq. ft)	Calculation
FLOOR 1 (Living area)	699	$-\left((707.5 + 707.5) * (157 - 316.2) + (707.5 + 678.4) * (316.2 - 316.2) + (678.4 + 678.4) * (316.2 - 463.1) + (678.4 + 364.5) * (463.1 - 463.1) + (364.5 + 364.5) * (463.1 - 163) + (364.5 + 370.5) * (163 - 163) + (370.5 + 370.5) * (163 - 157) + (370.5 + 707.5) * (157 - 157)\right) * 0.5 * 0.00694$
SCREENED PORCH (Non-living area)	185	$-\left((319.7 + 319.7) * (36.5 - 163) + (319.7 + 109) * (163 - 163) + (109 + 109) * (163 - 36.5) + (109 + 319.7) * (36.5 - 36.5)\right) * 0.5 * 0.00694$
PATIO (Non-living area)	324	$-\left((707.1 + 707.5) * (36.5 - 157) + (707.5 + 319.7) * (157 - 157) + (319.7 + 319.7) * (157 - 36.5) + (319.7 + 707.1) * (36.5 - 36.5)\right) * 0.5 * 0.00694$

# 905 Utsonati Lane, Brevard, North Carolina 28712, United States

Gross Living Area: 2530 sq. ft



Space	Area (sq. ft)	Calculation <small>Coordinate Polygon Area Algorithm using inches</small>
FLOOR 2 (Living area)	1831	$  \begin{aligned}  & -((493 + 493) * (36.5 - 75.9) + (493 + 579.4) * (75.9 - 75.9) + (579.4 + 579.4) * (75.9 - 36.5) + \\  & (579.4 + 707.5) * (36.5 - 36.5) + (707.5 + 707.5) * (36.5 - 316.2) + (707.5 + 678.4) * (316.2 - \\  & 316.2) + (678.4 + 678.4) * (316.2 - 475.3) + (678.4 + 570.6) * (475.3 - 475.3) + (570.6 + 570.6) * \\  & (475.3 - 616.8) + (570.6 + 364.5) * (616.8 - 616.8) + (364.5 + 364.5) * (616.8 - 475.3) + (364.5 + \\  & 109) * (475.3 - 475.3) + (109 + 109) * (475.3 - 157) + (109 + 275.1) * (157 - 157) + (275.1 + \\  & 275.1) * (157 - 36.5) + (275.1 + 493) * (36.5 - 36.5) * 0.5 * 0.00694 + -((564.6 + 370.5) * (475.3 - \\  & 475.3) + (370.5 + 370.5) * (475.3 - 475.9) + (370.5 + 564.6) * (475.9 - 475.9) + (564.6 + 564.6) *  \end{aligned}  $

# 905 Utsonati Lane, Brevard, North Carolina 28712, United States

Gross Living Area: 2530 sq. ft

Space	Area (sq. ft)	Calculation <small>Coordinate Polygon Area Algorithm using inches</small>
BALCONY (Non-living area)	131	$(475.9 - 475.3) * 0.5 * 0.00694$ $-((275.1 + 275.1) * (40.5 - 157) + (275.1 + 113) * (157 - 157) + (113 + 113) * (157 - 40.5) + (113 + 275.1) * (40.5 - 40.5)) * 0.5 * 0.00694$
PORCH (Non-living area)	183	$-((364.5 + 364.5) * (475.3 - 547.5) + (364.5 + 331.1) * (547.5 - 547.5) + (331.1 + 331.1) * (547.5 - 602.8) + (331.1 + 298.8) * (602.8 - 689.7) + (298.8 + 241.8) * (689.7 - 689.7) + (241.8 + 241.5) * (689.7 - 642.9) + (241.5 + 263.1) * (642.9 - 642.9) + (263.1 + 277.4) * (642.9 - 602.8) + (277.4 + 277.4) * (602.8 - 547.5) + (277.4 + 113) * (547.5 - 547.5) + (113 + 113) * (547.5 - 475.3) + (113 + 364.5) * (475.3 - 475.3)) * 0.5 * 0.00694$
PATIO (Non-living area)	24	$-((579.4 + 579.4) * (36.5 - 75.9) + (579.4 + 493) * (75.9 - 75.9) + (493 + 493) * (75.9 - 36.5) + (493 + 579.4) * (36.5 - 36.5)) * 0.5 * 0.00694$